

PLAT OF SURVEY

THE WEST 150.00 FEET OF
LOT 6, BLOCK 17 DELMAR
A SUBDIVISION LOCATED IN THE
SOUTHWEST 1/4 OF THE SOUTHWEST 1/4,
THE SOUTHEAST 1/4 OF THE SOUTHWEST 1/4, AND
THE NORTHEAST 1/4 OF THE SOUTHWEST 1/4,
SECTION 27, TOWN 2 NORTH, RANGE 16 EAST,
TOWN OF DELAVAN, WALWORTH COUNTY,
WISCONSIN

SUTTER AVENUE
(50' WIDE)

(EAST 150.00)
S 89°58'20" E 149.70

FENCE CORNER
0.7' EAST &
0.2' SOUTH OF
PROPERTY LINE

FENCE CORNER
0.3' SOUTH OF
PROPERTY LINE

LOT 5

LOT 2

CSM 12127

LOT 6

38,961 SQ. FT.

10.3
10.0
10.0
10.3
6.0'
N 00°09'23" W 261.65
(NORTH 261.17)

FENCE CORNER
ON PROPERTY
LINE

S 00°10'54" E 258.64
(SOUTH)

LOT 1

FENCE CORNER
0.2' EAST OF
PROPERTY LINE

BEARINGS REFERENCED TO THE
SOUTH LINE OF LOT 6, BLOCK 17
RECORDED AS: S 88°53' W

10 5 0 10 20 30 40 50 60 70 80 90 100
MAP SCALE IN FEET ORIGINAL 1" = 20'

LEGEND

- - FOUND IRON PIPE
- ◇ - CHAIN LINK FENCE
- () - RECORDED AS

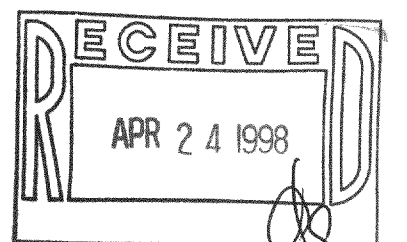

NOTE: COPIES OF THIS MAP TO WHICH THE FOLLOWING CERTIFICATE
WILL APPLY ARE BLUE LINE PRINTS SHOWING SURVEYOR'S ORIGINAL
SEAL AND SIGNATURE IN BLACK INK. COPIES BY ANY OTHER MEANS
MAY HAVE ALTERATIONS WHICH DO NOT REPRESENT THE SURVEYOR'S
WORK PRODUCT.

I HEREBY CERTIFY THAT THE ABOVE DESCRIBED PROPERTY HAS BEEN
SURVEYED UNDER MY DIRECTION AND THAT THE ABOVE MAP IS A TRUE
REPRESENTATION THEREOF AND SHOWS THE SIZE AND LOCATION OF
THE PROPERTY AND ITS EXTERIOR BOUNDARIES. THIS SURVEY IS
MADE FOR THE USE OF THE PRESENT OWNERS OF THE PROPERTY, AND
ALSO THOSE WHO PURCHASE, MORTGAGE, OR GUARANTEE THE SAME
THERE TO WITHIN ONE YEAR FROM THE DATE HEREOF.

DATED: 2/24/98

PETER S. GORDON R.L.S. 2101

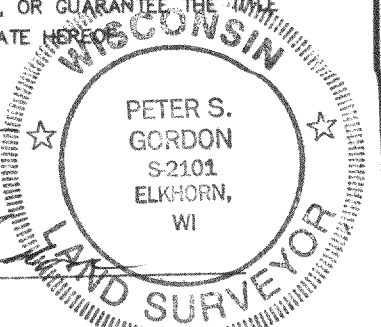

BAILEY ROAD
(66' WIDE)

FDM-474
216-2547

1 OF 1
SHEET NO.
DATE
2/24/98
PROJECT NO.
4936

FARRIS, HANSEN & ASSOCIATES, INC.
Engineering, Architecture, Surveying
7 Ridgway Court P.O. Box 437
ELKHORN, WISCONSIN 53121
Office: (414) 723-2098
Fax: (414) 723-5886

WORK ORDERED BY:
CLIFF & JOAN LENLING
706 BAILEY ROAD
DELAVAN, WISCONSIN 53115

BOUNDARY SURVEY
706 BAILEY ROAD
DELAVAN, WISCONSIN

