

PLAT OF SURVEY
 LOT 17
 SUMMIT MEADOWS SUBDIVISION
 LANDS LOCATED IN PART OF
 ALL 1/4'S OF THE NW 1/4
 SECTION 31, TOWN 2 NORTH, RANGE 16 EAST
 WALWORTH COUNTY, WISCONSIN

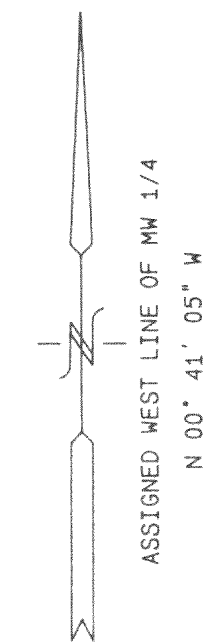

- = FOUND IRON REBAR STAKE
- = FOUND IRON PIPE STAKE
- ⊙ = SET IRON REBAR STAKE
- (X X) = RECORDED AS

NOTE: COPIES OF THIS MAP TO WHICH THE FOLLOWING CERTIFICATE WILL APPLY ARE BLUE LINE PRINTS SHOWING SURVEYOR'S ORIGINAL SEAL AND SIGNATURE IN BLACK INK. COPIES BY ANY OTHER MEANS MAY HAVE ALTERATIONS WHICH DO NOT REPRESENT THE SURVEYOR'S WORK PRODUCT.

I HEREBY CERTIFY THAT THE ABOVE DESCRIBED PROPERTY HAS BEEN SURVEYED UNDER MY DIRECTION AND THAT THE ABOVE MAP IS A TRUE REPRESENTATION THEREOF AND SHOWS THE SIZE AND LOCATION OF THE PROPERTY AND ITS EXTERIOR BOUNDARIES. THIS SURVEY IS MADE FOR THE USE OF THE PRESENT OWNERS OF THE PROPERTY, AND ALSO THOSE WHO PURCHASE, MORTGAGE, OR GUARANTEE THE TITLE THERETO WITHIN ONE YEAR FROM THE DATE HEREOF.

DATED: 10/21/95
 REV: 11/7/95
 RESURVEY 9-11-1996

Peter S. Gordon
 PETER S. GORDON R.L.S. 2101

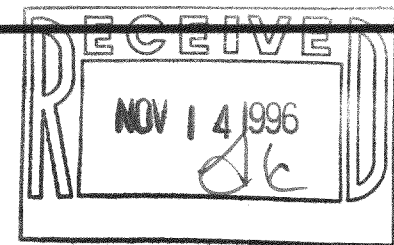
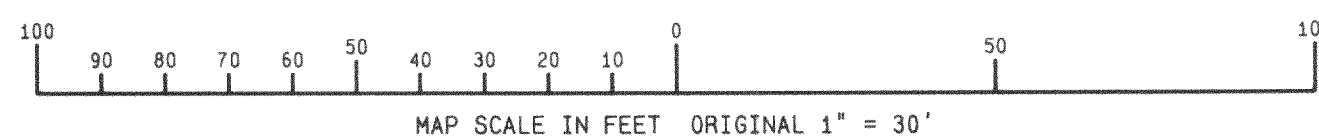
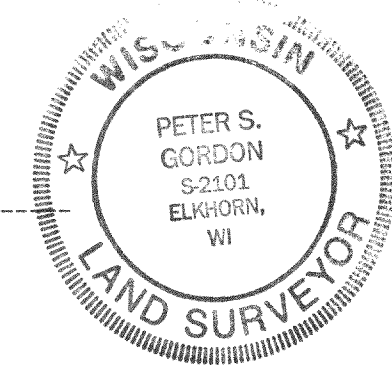

OWNER
 B. R. AMON & SONS
 R.T. 3
 ELKHORN, WISCONSIN 53121

FARRIS, HANSEN & ASSOCIATES, INC.
 Engineering, Architecture, Surveying
 7 Ridgway Court, P.O. Box 437
 ELKHORN, WISCONSIN 53121
 Office: (414) 723-2098
 Fax: (414) 723-3686

REVISIONS

PROJECT NO.
 3477.17
 DATE
 10/27/95
 SHEET NO.
 1 OF 1

FSM-17
 216-2378