

PLAT OF SURVEY
LOT 4
SUMMIT MEADOWS SUBDIVISION
LANDS LOCATED IN PART OF
ALL 1/4'S OF THE NW 1/4
SECTION 31, TOWN 2 NORTH, RANGE 16 EAST
WALWORTH COUNTY, WISCONSIN

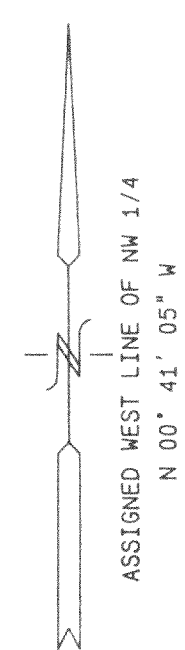

- = FOUND IRON REBAR STAKE
- = FOUND IRON PIPE STAKE
- = SET IRON REBAR STAKE
- (xxx) = RECORDED AS

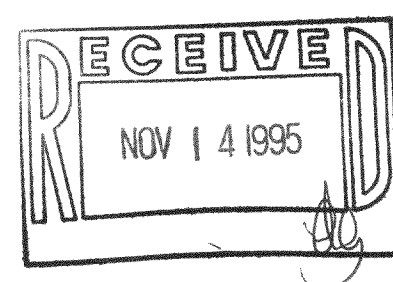

NOTE: COPIES OF THIS MAP TO WHICH THE FOLLOWING CERTIFICATE WILL APPLY ARE BLUE LINE PRINTS SHOWING SURVEYOR'S ORIGINAL SEAL AND SIGNATURE IN BLACK INK. COPIES BY ANY OTHER MEANS MAY HAVE ALTERATIONS WHICH DO NOT REPRESENT THE SURVEYOR'S WORK PRODUCT.

I HEREBY CERTIFY THAT THE ABOVE DESCRIBED PROPERTY HAS BEEN SURVEYED UNDER MY DIRECTION AND THAT THE ABOVE MAP IS A TRUE REPRESENTATION THEREOF AND SHOWS THE SIZE AND LOCATION OF THE PROPERTY AND ITS EXTERIOR BOUNDARIES. THIS SURVEY IS MADE FOR THE USE OF THE PRESENT OWNERS OF THE PROPERTY, AND ALSO THOSE WHO PURCHASE, MORTGAGE, OR GUARANTEE THE TITLE THERETO WITHIN ONE YEAR FROM THE DATE HEREOF.

DATED: 10/27/95

Peter S. Gordon
PETER S. GORDON R.L.S. 2101



OWNER
B.R. AMON & SONS
RT. 3
ELKHORN, WISCONSIN 53121

FARRIS, HANSEN & ASSOCIATES, INC.
Engineering, Architecture, Surveying
7 Ridgway Court, P.O. Box 437
ELKHORN, WISCONSIN 53121
Office: (414) 723-2098
Fax: (414) 723-5886

REVISIONS

PROJECT NO.
3477.04
DATE
10/27/95
SHEET NO.
1 OF 1

FSM-4
216-2155