

PLAT OF SURVEY

20'

20'

20'

20'

FIRST STREET

40 FEET WIDE

S 89°51'31" E 208.00'

50.05'  
(50')

50.04'  
(50')

LOT 26

LOT 25

LOT 24

lot 23

ALLEY 20' WIDE  
N 36°33'47" E 173.51'

EXISTING RESIDENCE

PROPOSED GARAGE

SHED  
non-permanent

BEARING BASIS FOR THIS PLAT  
S 0°21'00" E 140.00'

LOTS 24-26 INCLUSIVE OF BLOCK 1 OF  
INLET OAKS SUBDIVISION NO. 3,  
LOCATED IN SECTION 22, TOWN 2 NORTH,  
RANGE 16 EAST, WALWORTH COUNTY,  
WISCONSIN.

OWNERS: DUANE AND BARBARA STINER  
417 FIRST STREET  
DELAVER, WI. 53115

lot 1

lot 2

N 88°22'45" E 105.50'

49.92'  
(50')

50.06'  
(50')

BEARINGS ARE BASED ON PREVIOUS SURVEYS OF RECORD

SCALE 1" = 20 FEET

Legend

- FOUND IRON PIPE
- FOUND IRON ROD
- FOUND BRASS CAPPED MONUMENT
- FOUND CONCRETE MONUMENT
- CHISEL CUT IN CONCRETE
- SET IRON ROD, 24" LONG, WEIGHING 1.5 LBS./LINEAL FT., 3/4" DIA.
- SET IRON ROD, 30" LONG, WEIGHING 4.5 LBS./LINEAL FT., 1-11/16" DIA.
- RECORDED AS DIMENSION
- EXISTING FENCE

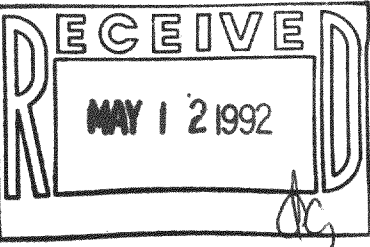

SCALE: 1" = 20 FEET

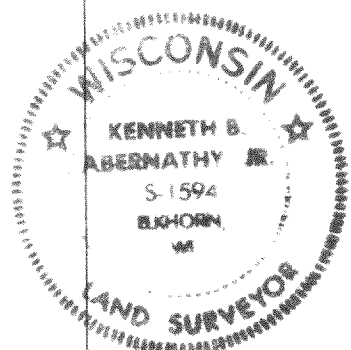

"I hereby certify that I have surveyed the above described property and that the above map is a true representation thereof and shows the size and location of the property, its exterior boundaries, the location of all visible structures and dimensions of all principal buildings thereon, boundary fences, apparent easements, roadways and visible encroachments, if any."  
"This survey is made for the use of the present owners of the property, and also those who purchase, mortgage, or guarantee the title thereto within one year from date hereof."

*Kenneth B. Abernathy Jr.*  
KENNETH B. ABERNATHY, JR.  
WISCONSIN REGISTERED LAND SURVEYOR,  
S-1594

Date: 12/8/91 Job No. 911201