

ABERNATHY and ASSOCIATES
Kenneth B. Abernathy Jr.
 Wisconsin Registered Land Surveyor S-1594

Rt. 3, Box 273
 Elkhorn, Wisconsin 53121
 Phone: (414) 723-4260 (office)
 (414) 723-4813 (residence)

PLAT OF SURVEY

**LOT 3 OF BLOCK 2 OF WOODLAWN BAY
 COMMUNITY, TOWN 2 NORTH, RANGE 16
 EAST, WALWORTH COUNTY, WISCONSIN.**

**ORDERED BY: ROBERTS REALTY
 P.O. BOX 1078
 WILLIAMS BAY, WI. 53191**

**OWNERS: GUERRINO AND ANN VENZON
 C/O MARK VENZON
 4201 LOCUST
 DELAVAN, WI. 53115**

LOT 9

LOT 4

PROPOSED RESIDENCE

2

LOT 10

LOT 3
 0.21 AC.

(158.52')
 N 90°00'00" E 158.49'

UNDERGROUND UTILITIES
 N 0°14'04" E 59.80'
 (SOUTH 80')

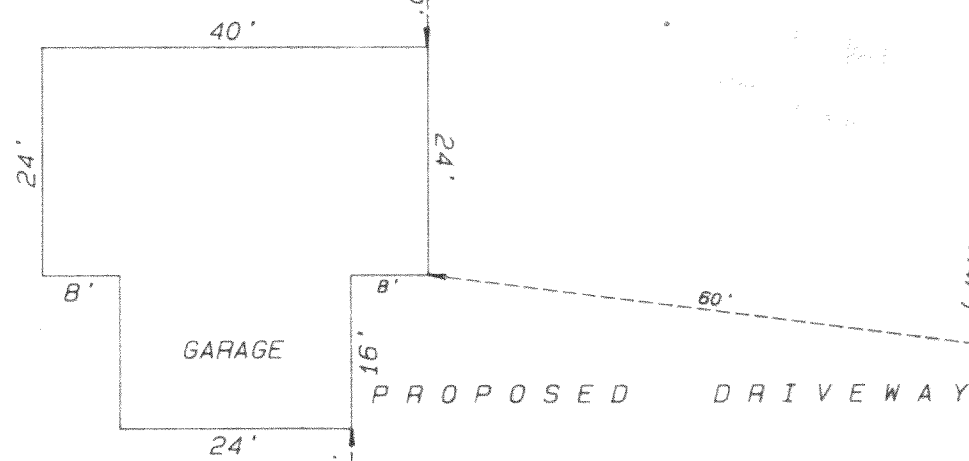

OVERHEAD ELECTRIC LINES
 S 7°22'20" W 60.53'
 (.44' 09" M.I.T./S)

N 89°54'55" W 150.97'
 (EAST 150.96')

LOT 11

LOT 2

BLOCK

MARINE
 TERRACE
 66' WIDE

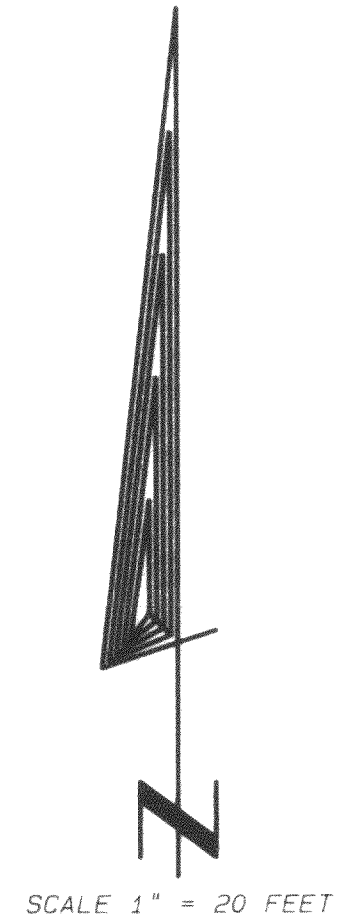

SCALE 1" = 20 FEET

Legend

- FOUND IRON PIPE
- FOUND IRON ROD
- FOUND BRASS CAPPED MONUMENT
- FOUND CONCRETE MONUMENT
- + CHISEL CUT IN CONCRETE
- SET IRON ROD, 24" LONG, WEIGHING 1.5 LBS./LINEAL FT., 3/8" DIA.
- SET IRON ROD, 30" LONG, WEIGHING 4.5 LBS./LINEAL FT., 1-11/16" DIA.
- (xx) RECORDED AS DIMENSION
- x-x- EXISTING FENCE

NOTE:

THIS SURVEY RETRACES A PREVIOUS PLAT OF SURVEY DONE BY ABELL SURVEYING AND MAPPING DATED APRIL 4, 1990.

SCALE: 1" = 20 FEET

I hereby certify that I have surveyed the above described property and that the above map is a true representation thereof and shows the size and location of the property, its exterior boundaries, the location of all visible structures and dimensions of all principal buildings thereon, boundary fences, apparent easements, roadways and visible encroachments, if any.
 This survey is made for the use of the present owners of the property, and also those who purchase, mortgage, or guarantee the title thereto within one year from date hereof.

RECEIVED
 OCT 3 1991



Kenneth B. Abernathy Jr.
 KENNETH B. ABERNATHY, JR.
 WISCONSIN REGISTERED LAND SURVEYOR,
 S-1594
 Date: 8/22/91 Job No. 91.815