

PLAT OF SURVEY

Lots 28, 29, & 30 of Block 2 of Inlet Oaks  
Subdivision Number 4, Located in Section  
15, Town 2 North, Range 16 East, Town of  
Delavan, County of Walworth, State of  
Wisconsin.

Owners : Gary & Jill Weckesser  
Route 2, Box 365  
Delavan, Wisconsin

53115

Legal Description recorded in Volume 218,  
Page 148, Document Number 37622, Walworth  
County Register of Deeds Office, Elkhorn,  
Wisconsin.



- Legend**
- FOUND IRON PIPE
  - FOUND IRON ROD
  - FOUND BRASS CAPPED MONUMENT
  - FOUND CONCRETE MONUMENT
  - + CHISEL CUT IN CONCRETE
  - SET IRON ROD, 24" LONG, WEIGHING 1.5 LBS./LINEAL FT., 3/4" DIA.
  - SET IRON ROD, 36" LONG, WEIGHING 4.5 LBS./LINEAL FT., 1-11/16" DIA.
  - (xx) RECORDED AS DIMENSION
  - - - EXISTING FENCE

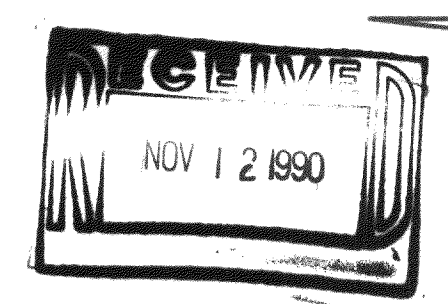

SCALE: 1" = 30' FEET

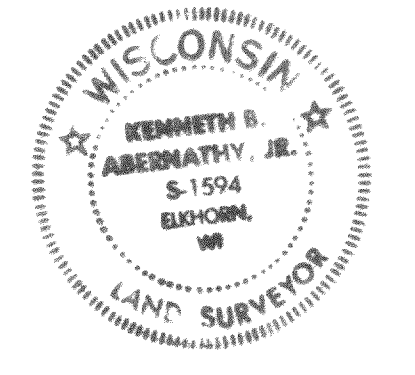

"I hereby certify that I have surveyed the above described property and that the above map is a true representation thereof and shows the site and location of the property, its exterior boundaries, the location of all visible structures and dimensions of all principal buildings thereon, boundary fences, apparent easements, roadways and visible encroachments, if any."

"This survey is made for the use of the present owners of the property, and also those who purchase, mortgage, or guarantee the title thereto within one year from date hereof."

*Kenneth B. Abernathy Jr.*  
KENNETH B. ABERNATHY, JR.  
WISCONSIN REGISTERED LAND SURVEYOR,  
S-1594  
Date: 7-9-90 Job No. 9060