

PLAT OF SURVEY  
LOT 16 OF  
SUMMIT MEADOWS

LOCATED IN ALL 1/4'S OF THE NW 1/4  
SECTION 31, TOWN 2 NORTH, RANGE 16 EAST  
WALWORTH COUNTY, WISCONSIN

SUMMIT DRIVE  
66' WIDE PUBLIC ROW

C=149.68  
A=150.00  
R=667.00  
S 86° 24' 22" E

U.T. BOX

U.T. BOX  
TRANSFORMER

N 00° 37' 28" W  
287.05

LOT 16  
42,655 S.F.

S 01° 31' 55" W  
300.09

LOT 17

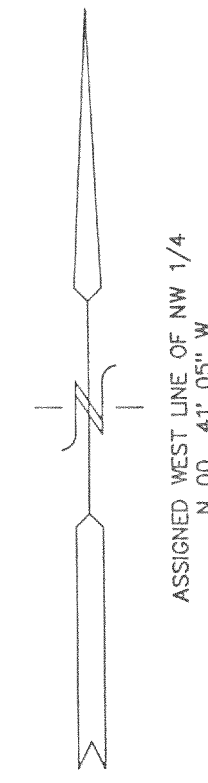

LEGEND

● = FOUND IRON REBAR STAKE

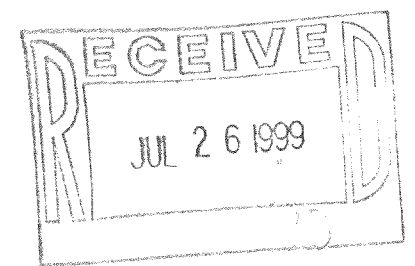

NOTE: COPIES OF THIS MAP TO WHICH THE FOLLOWING CERTIFICATE  
WILL APPLY SHOW SURVEYOR'S ORIGINAL  
SEAL AND SIGNATURE IN RED INK. COPIES BY ANY OTHER MEANS  
MAY HAVE ALTERATIONS WHICH DO NOT REPRESENT THE SURVEYOR'S  
WORK PRODUCT.

I HEREBY CERTIFY THAT THE ABOVE DESCRIBED PROPERTY HAS BEEN  
SURVEYED UNDER MY DIRECTION AND THAT THE ABOVE MAP IS A TRUE  
REPRESENTATION THEREOF AND SHOWS THE SIZE AND LOCATION OF  
THE PROPERTY AND ITS EXTERIOR BOUNDARIES. THIS SURVEY IS  
MADE FOR THE USE OF THE PRESENT OWNERS OF THE PROPERTY, AND  
ALSO THOSE WHO PURCHASE, MORTGAGE, OR GUARANTEE THE TITLE  
THERE TO WITHIN ONE YEAR FROM THE DATE HEREOF.

DATED: 7-6-99

*Peter S. Gordon*  
PETER S. GORDON R.L.S. 2101

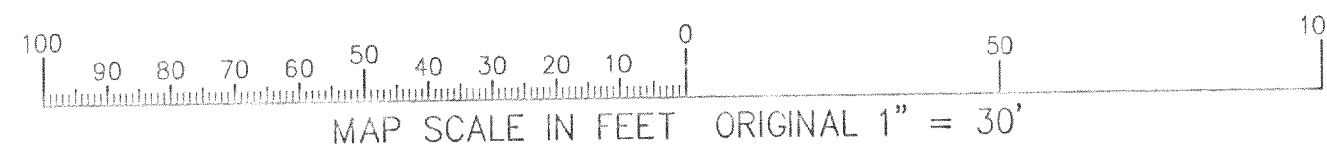

WORK ORDERED BY: THE RAULAND AGENCY  
FOR TOM AMON  
P.O. BOX 159  
WALWORTH, WISCONSIN

FARRIS, HANSEN & ASSOCIATES, INC.  
Engineering, Architecture, Surveying  
7 Ridgeway Court P.O. Box 437  
ELKHORN, WISCONSIN 53121  
Office: (414) 723-2098  
Fax: (414) 723-5886

REVISIONS

PROJECT NO.  
3477.16  
DATE:  
07-06-99  
SHEET NO.  
1 OF 1

216-2737