

Center 1/4 Corner
Section 10-2-15
N. 238,322.65
E. 2,347,563.84

Plat of Survey

of

Lot 1 of Certified Survey Map No. 3111,

recorded in Vol. 17 of Certified Survey Maps of Walworth County on Page 41 as Document No. 415593 and located in the Northwest 1/4 and the Southwest 1/4 of the Southeast 1/4 of Section 10, Town 2 North, Range 15 East, Town of Darien, Walworth County, Wisconsin.

EXCEPTING THEREFROM Parcel 27 of Transportation Project Plat 1320-17-20 - 4.06, recorded in Transportation Project Plats, as Document 934739 recorded in Walworth County, Wisconsin.

Surveyed for:

Matt & Tracy Smith

W8264 Highway 11
Delavan, Wisconsin. 53115

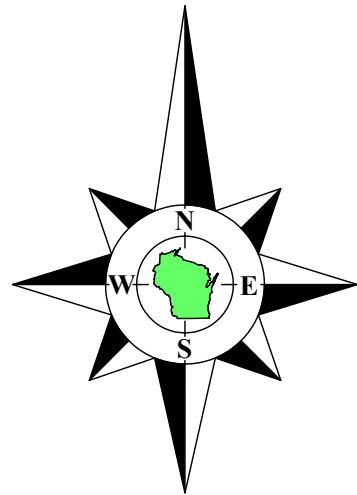

Bearings referenced to the South line of the Southeast 1/4 of Section 10-2-15, recorded as N87°20'22"E in the Wisconsin State Plane Coordinate System, South Zone, (NAD-27).

Coordinates are referenced to the Wisconsin State Plane Coordinate System, South Zone, (NAD-27).

Tax Parcel
BD 1000002

Part of
Lot 1
Tax Parcel
BA311100001

4.939 Acres
215,138 Sq.Ft.

Tax Parcel
BD 1000002

Survey Date: September 28, 2023.
Revisions:

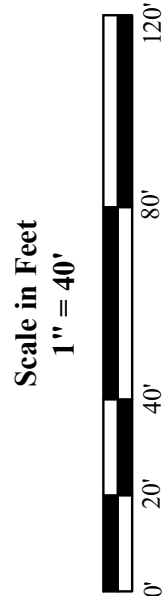

45 South Wisconsin Street | P.O. Box 322
Elkhorn, Wisconsin, 53121
Telephone: (262) 723-3434
Facsimile: (262) 723-8044
Email: doug@olsonsurveying.com
Website: www.olsonsurveying.com

OLSON
LAND SURVEYING, LLC
Rural | Residential | Commercial

Legend of Symbols & Abbreviations
N North
S South
E East
W West
Found County Section Corner
Found Iron Pipe
Found Iron Rod with Cap
Set Iron Pipe, 1" dia.
Recorded Information
Utility Pole
Concrete Surface
Asphalt Surface
Brick Pavers
No Cap
Access
Restriction
Residential
Utility Pedestal
Septic Vent
Inches

Sheet 1 of 1 Sheets

Drawing Name:
Job Reference Number
2023.085

2023.085

recorded as(N1°33'52"W 2651.62')State Plane
N1°33'52"W 2651.62'
West line of the Southeast 1/4 of Section 10-2-15

N1°33'52"W 1171.70'
recorded as(N1°33'52"W 1171.29')CSM 3111
recorded as(N0°34'08"W 1171.70')ROW Plat

recorded as(S75°06'06"E 163.90')
S76°06'00"E 163.72'
Overhead Wires
N12°54'00"W 43.00'

recorded as(S71°17'16"E 150.33')
S72°15'47"E 160.41'
121.57'

Utility Easement
As shown on CSM 3111
No Access As Shown
N72°15'47"W 28.83'

Foundation

Barn

60.4' Elec. Meter

House
W8264

Well

State Trunk Highway 11
(Width Varies)

Pool

recorded as(S0°47'40"E 503.09')
S0°47'26"E 502.81'

Edge of Farm Field & Mown Lawn
S0°47'26"E 492.17'

recorded as(S76°05'18"E 392.79')
S76°04'42"E 392.68'
Edge of Farm Field & Mown Lawn

Copyright © 2023 by Olson Land Surveying, LLC.

All rights reserved. No part of this survey plat may be reproduced or transmitted in any form by any means - graphic, electronic, or mechanical, including photocopying, tracing, or information storage and retrieval systems - without permission in writing from Douglas G. Olson, Olson Land Surveying, LLC.

I hereby certify that I have surveyed the above described property in compliance with Chapter A-E 7 of the Wisconsin Administrative Code and that the map hereon is correct to the best of my professional knowledge and belief and shows the size and location of the property, its exterior boundaries, the location and dimensions of all visible structures thereon, boundary fences, apparent easements and roadways and visible encroachments, if any.

This survey is made for the exclusive use of the present owners of the property, and also those who purchase, mortgage or guarantee title thereto, within one year from the date hereof.

Douglas G. Olson
Wisconsin Professional Land Surveyor - 2093

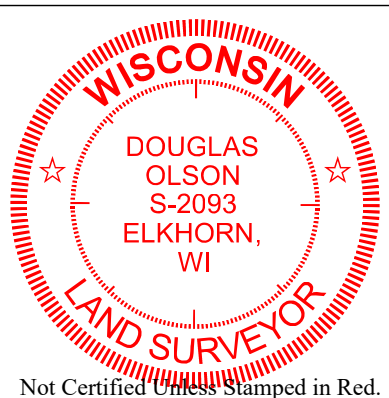

Notes:

- This Plat of Survey is not certified unless signed and sealed in red ink.
- This survey is subject to Wisconsin lien laws. This Plat of Survey is the notice of intent to file lien. Lien waiver required.
- The Survey Date shown on this Plat of Survey is the completion date of the field work.

South 1/4 Corner
Section 10-2-15
N. 235,672.08
E. 2,347,656.23

South line of the Southeast 1/4 of Section 10-2-15
N87°20'22"E 2652.73'
recorded as(N87°20'22"E 2652.91')State Plane

Southeast Corner
Section 10-2-15
N. 235,795.22
E. 2,350,306.22