

Center 1/4 Corner
Section 21-2-16
N. 228,547.68
E. 2,374,253.11

West line of the Southeast 1/4 of Section 21-2-16.
N0°44'28"W 2626.86'
recorded as(N0°44'28"W 2626.90')

**** Note A:**

Curved street lines are not adequately dimensioned on the plat of Delavan Lake Assembly Grounds. Lines are shown using dimensions from the recorded plat or as determined from found survey monuments and are approximate.

Plat of Survey

of
Lots 19, 20 & 21 in Block E of Delavan Lake Assembly Grounds,
a subdivision located in Government Lot 3 in the Southeast 1/4 of Section 21, Town 2 North,
Range 16 East, Town of Delavan, Walworth County, Wisconsin.

Surveyed for: **James & Marguerite Ignoffo**
3N 442 Jill Court
Elmhurst, Illinois. 60126

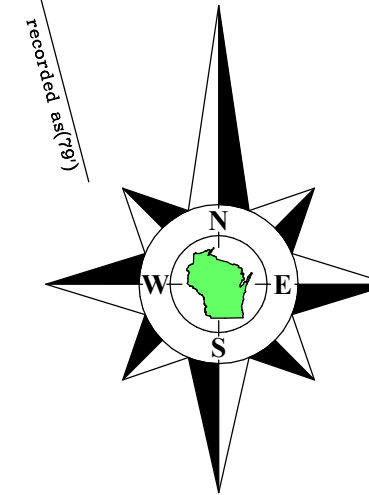

Lot 17

Bearings referenced to the East line of the Southwest 1/4 of Section 9-3-17,
recorded as N1°50'18"W in the Wisconsin State Plane Coordinate System,
South Zone, (NAD-27).

Coordinates are referenced to the Wisconsin State
Plane Coordinate System, South Zone, (NAD-27).

Scale in Feet
1" = 10'



45 South Wisconsin Street | P.O. Box 322
Elkhorn, Wisconsin, 53121
Telephone: (262) 723-3434
Facsimile: (262) 723-8044
Email: doug@olsonsurveying.com
Website: www.olsonsurveying.com

OLSON
LAND SURVEYING, LLC
Rural | Residential | Commercial

North
North Arrow
East
West
Bearing
in
Minutes
Seconds
in
Feet
in
Inches

Legend of Symbols & Abbreviations
Found County Section Corner
Found Iron Pipe
Recorded Information
Utility Pole
Manhole
Utility Pedestal
Asphalt Surface
Concrete Surface
Brick Pavers

Sheet 1 of 1 Sheets
Drawing Name:
Job Reference Number
2021.123

2021.123

Tax Parcel
FDLA 00075
** 0.145 Acre
** 6,320 Sq.Ft.

Lot 20

House
No. 1613

House

Lot 18

Lot 19

Block

Lot 9

Lot 8

Lot 7

Lot 6

Lot 5

Lot 4

Lot 3

South 1/4 Corner
Section 21-2-16
N. 225,921.05
E. 2,374,287.09

Notes:

- This Plat of Survey is not certified unless signed and sealed in red ink.
- This survey is subject to Wisconsin lien laws. This Plat of Survey is the notice of intent to file lien. Lien waiver required.
- The Survey Date shown on this Plat of Survey is the completion date of the field work.

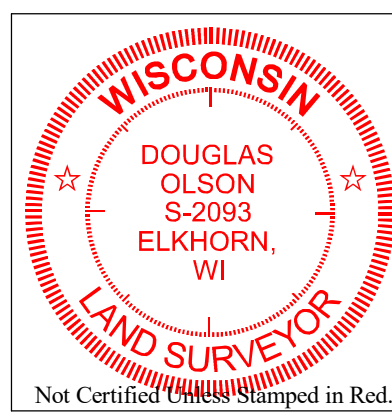

Copyright ©2021 by Olson Land Surveying, LLC.

All rights reserved. No part of this survey plat may be reproduced or transmitted in any form by any means - graphic, electronic, or mechanical, including photocopying, tracing, or information storage and retrieval systems - without permission in writing from Douglas G. Olson, Olson Land Surveying, LLC.

I hereby certify that I have surveyed the above described property in compliance with Chapter A-E 7 of the Wisconsin Administrative Code and that the map hereon is correct to the best of my professional knowledge and belief and shows the size and location of the property, its exterior boundaries, the location and dimensions of all visible structures thereon, boundary fences, apparent easements and roadways and visible encroachments, if any.

This survey is made for the exclusive use of the present owners of the property, and also those who purchase, mortgage or guarantee title thereto, within one year from the date hereof.

Douglas G. Olson
Wisconsin Professional Land Surveyor - 2093