

Plat of Survey

of

Lot 1 of Certified Survey Map No. 1045,

recorded in Vol. 5 of Certified Survey Maps of Walworth County on Page 14 and located in the Northwest 1/4 and the Southwest 1/4 of the Southeast 1/4 of Section 19, Town 2 North, Range 15 East, Town of Darien, Walworth County, Wisconsin.

Surveyed for: **Freedom Forever**
1000 Remington Road
Schaumburg, Illinois. 60173

Tax Parcel
BD 1900007

Tax Parcel
BD 1900007

Lot 1
Tax Parcel
BA104500001

1.798 Acres
78,317 Sq.Ft.
1.579 Acres
68,794 Sq.Ft.
Exclusive of R.O.W.

Shed

Proposed Solar Array

Shed

House
N3387

Porch

Deck

Well

Tank

Tax Parcel
BD 1900007

Copyright© 2018 by Olson Land Surveying, LLC.

All rights reserved. No part of this survey plat may be reproduced or transmitted in any form by any means - graphic, electronic, or mechanical, including photocopying, tracing, or information storage and retrieval systems - without permission in writing from Douglas G. Olson, Olson Land Surveying, LLC.

I hereby certify that I have surveyed the above described property in compliance with Chapter A-E 7 of the Wisconsin Administrative Code and that the map hereon is correct to the best of my professional knowledge and belief and shows the size and location of the property, its exterior boundaries, the location and dimensions of all visible structures thereon, boundary fences, apparent easements and roadways and visible encroachments, if any.

This survey is made for the exclusive use of the present owners of the property, and also those who purchase, mortgage or guarantee title thereto, within one year from the date hereof.

Douglas G. Olson
Wisconsin Professional Land Surveyor - 2093

South 1/4 Corner
Section 19-2-15
(N. 224,486.75)
(E. 2,332,022.94)

recorded as (S88°45'05"W 2641.99') State Plane
S89°48'01"W 2642.08'

Southeast Corner
Section 19-2-15
(N. 224,544.32)
(E. 2,334,664.25)

Sheet 1 of 1 Sheets

Drawing Name:

Job Reference Number
2021.075

Legend of Symbols & Abbreviations

Found County Section Corner
Found Iron Pipe
Set Iron Pipe, 1" dia.
Recorded Information
Utility Pole
Concrete Cover
Asphalt Surface
Concrete Surface
Gravel Surface
Septic Vent
In Distances
Feet
Inches
North
South
East
West
In Bearings
Degrees
Minutes
Seconds
In Distances
Feet
Inches



45 South Wisconsin Street | P.O. Box 322
Elkhorn, Wisconsin. 53121
Telephone: (262) 723-3434
Facsimile: (262) 723-8044
Email: doug@olsonsurveying.com
Website: www.olsonsurveying.com

Scale in Feet
1" = 30'



Survey Date: November 7, 2018.
Revisions: No. 1 - Proposed Building
No. 2 - Proposed Solar
Array



Bearings referenced to the East line of Certified Survey Map No. 1045, recorded as N0°16'18"W, which produces a bearing of S89°48'01"W on the South line of the Southeast 1/4 of Section 19-2-15. A rotation of 1°02'56" from the Wisconsin State Plane Coordinate System, South Zone, (NAD-27).

Coordinates are referenced to the Wisconsin State Plane Coordinate System, South Zone, (NAD-27).

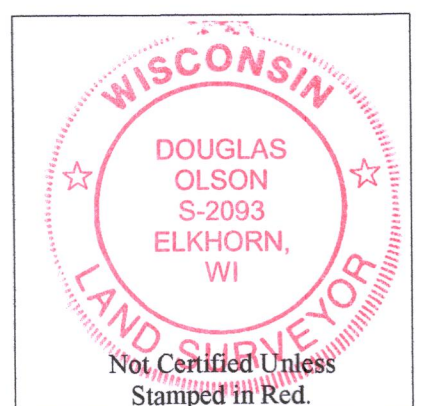

Notes:

- This Plat of Survey is not certified unless signed and sealed in red ink.
- This survey is subject to Wisconsin lien laws. This Plat of Survey is the notice of intent to file lien. Lien waiver required.
- The Survey Date shown on this Plat of Survey is the completion date of the field work.

2021.075