

REZONE & CONDITIONAL USE MAP LOT 1 OF CERTIFIED SURVEY MAP NO. 4069

LOCATED IN PART OF THE SE 1/4 OF THE NE 1/4 OF SECTION 30,
TOWN 2 NORTH, RANGE 15 EAST, WALWORTH COUNTY, WISCONSIN

TAX PARCEL B D 300002
OWNER: NORMAN D. FOLTS LIFE ESTATE
HARRIET ANN FOLTS LIFE ESTATE
187 CARTER RD.
MADISON, AL 35758
A-1 ZONING

TAX PARCEL B D 300002A
OWNER: JOHN CHARLES KAWATSKI LIFE ESTATE
W6604 NORTH LAKESHORE DR.
ELKHORN, WI 53121
A-1 ZONING

TAX PARCEL B D 300002
OWNER: NORMAN D. FOLTS LIFE ESTATE
HARRIET ANN FOLTS LIFE ESTATE
187 CARTER RD.
MADISON, AL 35758
A-1 ZONING

TAX PARCEL B D 300002
OWNER: NORMAN D. FOLTS LIFE ESTATE
HARRIET ANN FOLTS LIFE ESTATE
187 CARTER RD.
MADISON, AL 35758
A-1 ZONING

LOT 1 - C.S.M. 4069
184,432 S.F.
(4.23 ACRES)
2.87 ACRES OF A-1
LANDS REMAINING

REZONE PARCEL
A-1 ZONING TO A-4 ZONING
59,186 S.F. (1.36 ACRES)

LEGAL DESCRIPTION:

A PART OF LOT 1 OF CERTIFIED SURVEY MAP NO. 4069, RECORDED IN VOLUME 25 ON PAGE 209, AS DOCUMENT NO. 714322, LOCATED IN THE SOUTHEAST 1/4 OF THE NORTHEAST 1/4 OF SECTION 30, TOWN 2 NORTH, RANGE 15 EAST, WALWORTH COUNTY, WISCONSIN.
BEGINNING AT THE SOUTHWEST CORNER OF SAID CERTIFIED SURVEY MAP NO. 4069, THENCE N 02°01'51" W, 394.40 FEET; THENCE N 87°59'37" E, 175.61 FEET; THENCE S 01°08'59" E, 282.59 FEET; THENCE S 87°59'37" W, 79.96 FEET; THENCE S 01°45'35" E, 111.82'; THENCE S 87°58'34" W, 90.77 FEET TO THE POINT OF BEGINNING. CONTAINING 59,186 SQUARE FEET (1.36 ACRES) OF LAND, MORE OR LESS.

- LEGEND
- = FOUND IRON REBAR STAKE, 3/4" DIA.
 - ⦿ = SET IRON REBAR STAKE, 3/4" x 24" x 1.60 lbs/ft
 - {XXX} = RECORDED AS

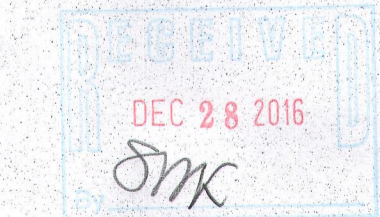

NOTE: COPIES OF THIS MAP TO WHICH THE FOLLOWING CERTIFICATE WILL APPLY SHOW THE SURVEYOR'S ORIGINAL SEAL AND SIGNATURE IN RED INK. COPIES BY ANY OTHER MEANS MAY HAVE ALTERATIONS WHICH DO NOT REPRESENT THE SURVEYOR'S WORK PRODUCT.

I HEREBY CERTIFY THAT THE ABOVE DESCRIBED PROPERTY HAS BEEN SURVEYED UNDER MY DIRECTION AND THAT THE ABOVE MAP IS A TRUE REPRESENTATION THEREOF AND SHOWS THE SIZE AND LOCATION OF THE PROPERTY AND ITS EXTERIOR BOUNDARIES. THIS SURVEY IS MADE FOR THE USE OF THE PRESENT OWNERS OF THE PROPERTY, AND ALSO THOSE WHO PURCHASE, MORTGAGE, OR GUARANTEE THE TITLE THERETO WITHIN ONE YEAR FROM THE DATE HEREOF.

DATED: NOVEMBER 30, 2016

Kristin Belongia
KRISTIN J. BELONGIA P.L.S. 2943

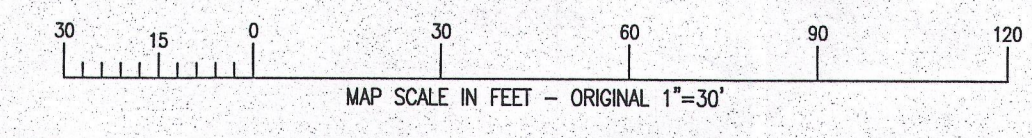
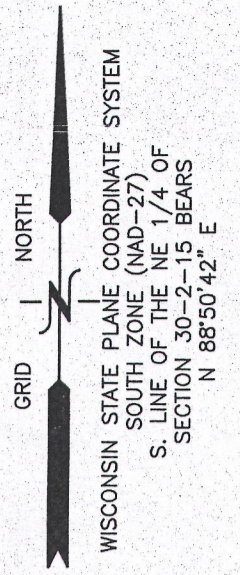

X:\Projects\8650\ACAD\8650.dwg

BA 4069-1

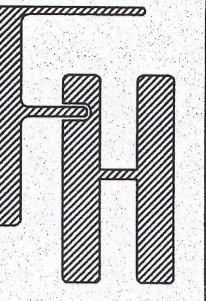

REZONE & CONDITIONAL USE MAP

WORK ORDERED BY -
TURTLE CREEK PROPERTIES, LLC
N3142 NORTH ROAD
DARIEN, WI 53114

FARRIS, HANSEN & ASSOCIATES, INC.
ENGINEERING - ARCHITECTURE - SURVEYING
7 RIDGWAY COURT P.O. BOX 437
ELKHORN, WISCONSIN 53121
OFFICE: (262) 723-2098 FAX: (262) 723-5886

REVISIONS

PROJECT NO.	9650
DATE	11/30/2016
SHEET NO.	1 OF 1

015-783