

# Property Exhibit

of  
Points Set Along the East Line

of  
**Tax Parcel B D 2300004,**

located in the Northwest 1/4 of Section 23, Town 2 North,  
Range 15 East, Town of Darien, Walworth County, Wisconsin.

Surveyed for: **Steve Fettig**  
N3620 Oak Hill Street  
Delavan, Wisconsin. 53115

Lot 1  
C.S.M. 1155

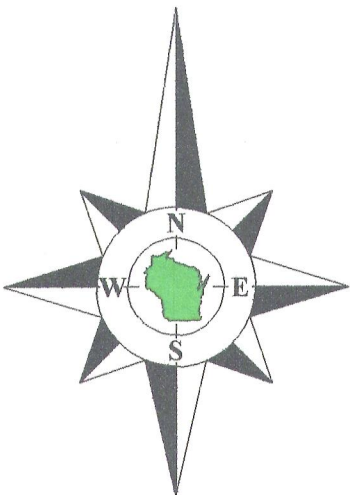

Bearings reference to Certified  
Survey Map No. 1155.

**Tax Parcel**  
**B D 2300004**  
(27.7 Acres)

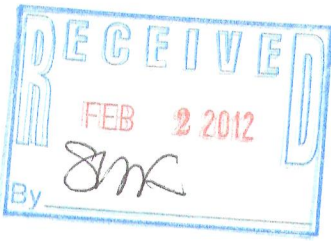
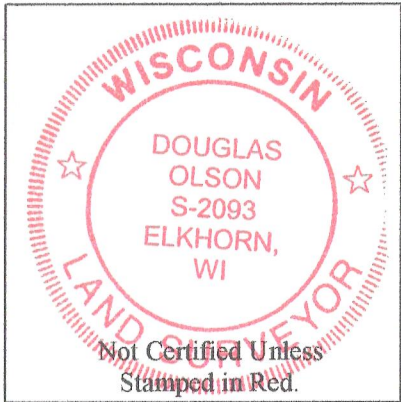

**Notes:**

- 1) This survey plat is not certified unless signed and sealed in red ink.
- 2) This survey is subject to Wisconsin lien laws. This Plat of Survey is the notice of intent to file lien. Lien waiver required.

**Creek Road** (66' Wide)

Copyright 2010 by Jensen & Olson Land Surveying, LLC.

All rights reserved. No part of this survey plat may be reproduced or transmitted in any form by any means - graphic, electronic, or mechanical, including photocopying, tracing, or information storage and retrieval systems - without permission in writing from Douglas G. Olson, Jensen & Olson Land Surveying, LLC.