

# Plat of Survey

of

## Lot 1 of Certified Survey Map No. 3390,

recorded in Vol. 19 of Certified Survey Maps of Walworth County on Page 208 and located in the Northeast 1/4 of Section 18, Town 2 North, Range 15 East, Town of Darien, Walworth County, Wisconsin.

Surveyed for: **Keefe Real Estate, Inc.**  
751 Geneva Parkway  
P.O. Box 460  
Lake Geneva, Wisconsin. 53147

Tax Parcel  
BD 1800001

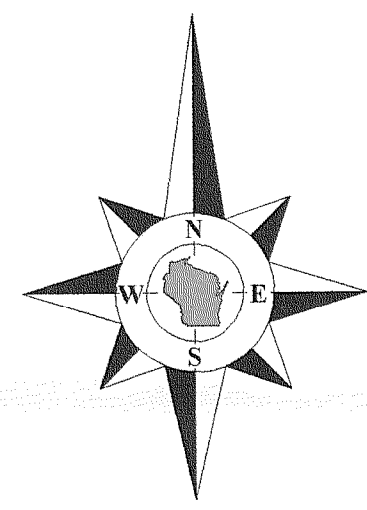

Bearings reference to the Wisconsin State Plane Coordinate System, South Zone.

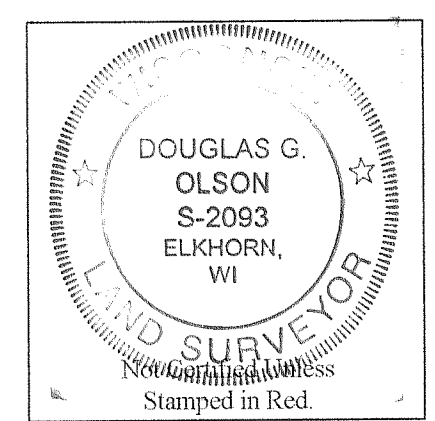

- Notes:**
- 1) This survey plat is not certified unless signed and sealed in red ink.
  - 2) This survey is subject to Wisconsin lien laws. This Plat of Survey is the notice of intent to file lien. Lien waiver required.

I hereby certify that I have surveyed the above described property and the map hereon is correct to the best of my professional knowledge and belief and shows the size and location of the property, its exterior boundaries, the location and dimensions of all visible structures thereon, boundary fences, apparent easements and roadways and visible encroachments, if any.

This survey is made for the exclusive use of the present owners of the property, and also those who purchase, mortgage or guarantee title thereto, within one year from the date hereof.

Douglas G. Olson  
Wisconsin Registered Land Surveyor - 2093

Copyright 2008 by Jensen & Olson Land Surveying, LLC.

All rights reserved. No part of this survey plat may be reproduced or transmitted in any form by any means - graphic, electronic, or mechanical, including photocopying, tracing, or information storage and retrieval systems - without permission in writing from Douglas G. Olson, Jensen & Olson Land Surveying, LLC.

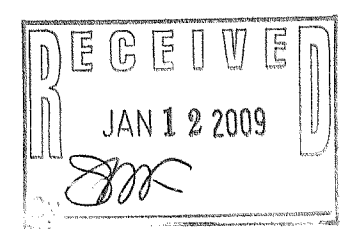

Survey Date: December 5, 2008.  
Revisions: No. 1 - Lot No.

Scale in Feet  
1" = 50'  
0' 25' 50' 100'

**Jensen & Olson Land Surveying, LLC**  
45 South Wisconsin Street \* P.O. Box 322 \* Elkhorn, Wisconsin. 53121  
Telephone: (262) 723-3434 \* Facsimile: (262) 723-8044  
Email: jensen.olson@elknet.net

**Legend**  
Found County Section Corner  
Found Iron Rod, 3/4" dia.  
Recorded Information  
Asphalt Surface  
Access Restriction

Sheet 1 of 1 Sheets  
Drawing Name:  
Job Reference Number  
**2008.126**

**2008.126**

BA 3390 -1

215-687