

Northwest Corner  
Section 4-2-15  
N. 245,904.20  
E. 2,339,600.56

# Plat of Survey

## A Proposed 1 Lot Certified Survey Map,

located in the Southwest 1/4 of the Northwest 1/4 of Section 4, Town 2 North, Range 15 East, Town of Darien, Walworth County, Wisconsin.

### Legal Description of Proposed 50' Wide Ingress, Egress & Utility Easement

A 50' Wide Ingress, Egress & Utility Easement located in the Southwest 1/4 of the Northwest 1/4 of Section 4, Town 2 North, Range 15 East, Town of Darien, Walworth County, Wisconsin, described as follows: Commence at the West 1/4 corner of said Section 4; thence North 87°32'29" East, along the South line of said Northwest 1/4 of Section 4, 33.21 feet to an iron pipe on the East line of State Trunk Highway 89 and the Point of Beginning; thence North 0°31'10" East, along said East line, 50.07 feet to an iron pipe; thence North 87°32'29" East 360.66 feet to an iron pipe; thence South 1°47'19" East 50.00 feet to an iron pipe on said South line of the Northwest 1/4 of Section 4; thence South 87°32'29" West, along said South line, 362.67 feet to the Point of Beginning.

Surveyed for: **Lisa A. Wheelock**  
N4692 Highway 89  
Darien, Wisconsin. 53114

**Tax Parcel**  
**BD 40007A**  
(85.68 Acres)

**Proposed**  
**Lot 1**  
5.850 Acres  
254,838 Sq.Ft.  
Zoned C-2

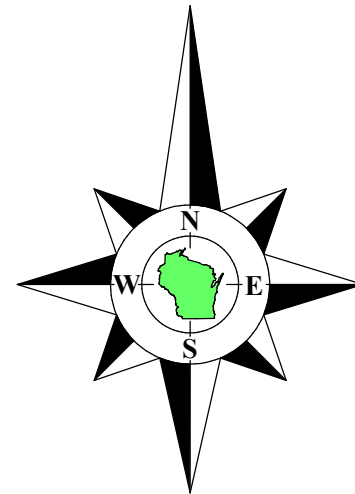

Bearings referenced to the West line of the Northwest 1/4 of Section 4-2-15, recorded as N0°32'34"W in the Wisconsin State Plane Coordinate System, South Zone, (NAD-27).

Coordinates are referenced to the Wisconsin State Plane Coordinate System, South Zone, (NAD-27).

**State Trunk Highway 89**

West line of the Northwest 1/4 of Section 4-2-15  
recorded as (N0°32'34"E 2631.17'  
(Width Varies)

N0°31'09"E 2283.60' Between W.D.O.T. P.I. Monuments  
recorded as (N0°31'03"E 2283.59')

West 1/4 Corner  
Section 4-2-15  
N. 243,273.30  
E. 2,339,575.63

**Proposed 50' Wide Ingress, Egress & Utility Easement**

N87°32'29"E 362.67'  
N87°32'29"E 395.88'

Edge of Farm Field  
Edge of Brush  
N1°47'19"W 266.19'  
216.19'

Edge of Farm Field  
Edge of Brush  
N28°42'38"E 250.20'

S87°47'33"E 449.50'

Edge of Farm Field  
Edge of Brush  
S1°57'04"E 443.71'

S87°32'29"W 576.68'

South line of the Northwest 1/4 of Section 4-2-15  
N87°32'29"E 2658.65'  
recorded as (N87°32'43"E 2658.49') State Plane

Center 1/4 Corner  
Section 4-2-15  
(N. 243,387.16)  
(E. 2,342,231.60)

**Tax Parcel**  
**BD 400008**

Copyright ©2022 by Olson Land Surveying, LLC.

All rights reserved. No part of this survey plat may be reproduced or transmitted in any form by any means - graphic, electronic, or mechanical, including photocopying, tracing, or information storage and retrieval systems - without permission in writing from Douglas G. Olson, Olson Land Surveying, LLC.

I hereby certify that I have surveyed the above described property in compliance with Chapter A-E 7 of the Wisconsin Administrative Code and that the map hereon is correct to the best of my professional knowledge and belief and shows the size and location of the property, its exterior boundaries, the location and dimensions of all visible structures thereon, boundary fences, apparent easements and roadways and visible encroachments, if any.

This survey is made for the exclusive use of the present owners of the property, and also those who purchase, mortgage or guarantee title thereto, within one year from the date hereof.

Douglas G. Olson  
Wisconsin Professional Land Surveyor - 2093

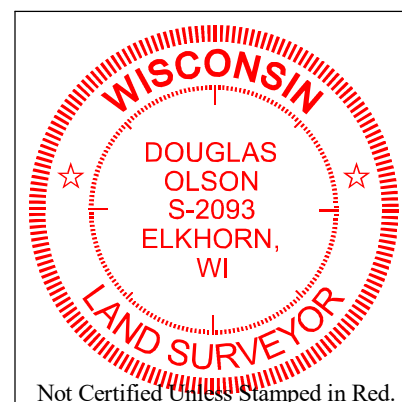

### Notes:

- 1) This Plat of Survey is not certified unless signed and sealed in red ink.
- 2) This survey is subject to Wisconsin lien laws. This Plat of Survey is the notice of intent to file lien. Lien waiver required.
- 3) The Survey Date shown on this Plat of Survey is the completion date of the field work.

Survey Date: June 27, 2022.  
Revisions:



45 South Wisconsin Street | P.O. Box 322  
Elkhorn, Wisconsin. 53121  
Telephone: (262) 723-3434  
Fax: (262) 723-8044  
Email: doug@olsonsurveying.com  
Website: www.olsonsurveying.com



Legend of Symbols & Abbreviations

North	North
East	East
West	West
South	South
Found Iron Pipe	Found W.D.O.T.
Set Iron Pipe	Found P.I. Mon.
Recorded Information with Cap.	Recorded Information with Cap.
Utility Pole	Concrete Mon.
Asphalt Surface	Soil Boring
Concrete Surface	Gravel Surface

Sheet 1 of 1 Sheets  
Drawing Name  
Job Reference Number  
**2022.026**

2022.026