

# Plat of Survey

of

## Lot 1 of Certified Survey Map No. 1045,

recorded in Vol. 5 of Certified Survey Maps of Walworth County on Page 14 and located in the Northwest 1/4 and the Southwest 1/4 of the Southeast 1/4 of Section 19, Town 2 North, Range 15 East, Town of Darien, Walworth County, Wisconsin.

Surveyed for: **Roger Millard**  
N3387 North Road  
Darien, Wisconsin. 53114

Tax Parcel  
BD 1900007

recorded as(N89°53'42"E 271.20')  
**N89°54'23"E 271.46'**  
238.14'  
238.46'  
(238.20')

**Lot 1**  
**Tax Parcel**  
**BA104500001**

1.798 Acres  
78,317 Sq.Ft.  
1.579 Acres  
68,794 Sq.Ft.  
Exclusive of R.O.W.

Tax Parcel  
BD 1900007

recorded as(N0°16'18"W 288.70')  
**N0°15'44"W 288.60'**

recorded as(N89°51'45"E 2644.70')  
1322.35'  
1322.35'

recorded as(N0°13'44"W 2645.44')  
**N0°13'44"W 2645.44'**  
recorded as(S0°13'44"E 288.58')  
**S0°13'44"E 288.58'**  
recorded as(S0°16'18"E 288.70')

**North Road**  
(66' Wide)

Tax Parcel  
BD 1900006

recorded as(S89°54'08"W 271.30')  
**S89°54'08"W 271.30'**  
recorded as(S89°53'42"W 271.20')

Tax Parcel  
BD 1900007

recorded as(S88°45'05"W 2641.99') State Plane  
**S89°48'01"W 2642.08'**

recorded as(N0°16'18"W 1042.22')  
**N0°16'18"W 1042.22'**  
recorded as(S0°16'18"E 288.70')

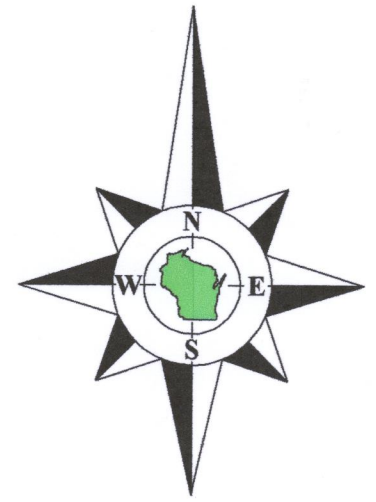

Bearings referenced to the East line of Certified Survey Map No. 1045, recorded as N0°16'18"W, which produces a bearing of S89°48'01"W on the South line of the Southeast 1/4 of Section 19-2-15. A rotation of 1°02'56" from the Wisconsin State Plane Coordinate System, South Zone, (NAD-27).

Coordinates are referenced to the Wisconsin State Plane Coordinate System, South Zone, (NAD-27).

Found pipe bent, dug down 1' until straight, straightened pipe & reset in that location.

Found pipe bent, dug down 1' until straight, set new pipe in that location.

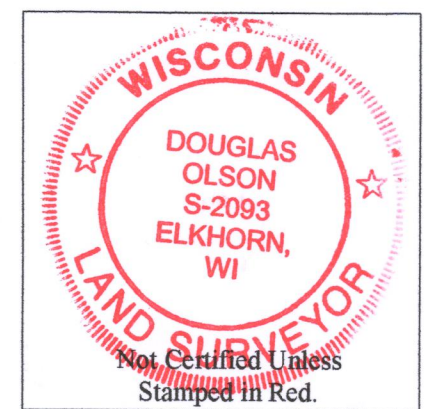
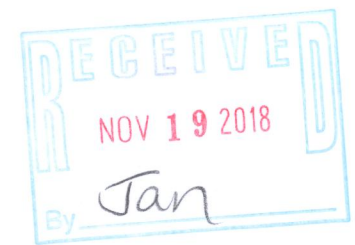

Copyright © 2018 by Olson Land Surveying, LLC.

All rights reserved. No part of this survey plat may be reproduced or transmitted in any form by any means - graphic, electronic, or mechanical, including photocopying, tracing, or information storage and retrieval systems - without permission in writing from Douglas G. Olson, Olson Land Surveying, LLC.

I hereby certify that I have surveyed the above described property in compliance with Chapter A-E 7 of the Wisconsin Administrative Code and that the map hereon is correct to the best of my professional knowledge and belief and shows the size and location of the property, its exterior boundaries, the location and dimensions of all visible structures thereon, boundary fences, apparent easements and roadways and visible encroachments, if any.

This survey is made for the exclusive use of the present owners of the property, and also those who purchase, mortgage or guarantee title thereto, within one year from the date hereof.

Douglas G. Olson  
Wisconsin Professional Land Surveyor - 2093

South 1/4 Corner  
Section 19-2-15  
(N. 224,486.75)  
(E. 2,332,022.94)

recorded as(S88°45'05"W 2641.99') State Plane  
**S89°48'01"W 2642.08'**

recorded as(N0°16'18"W 1042.22')  
**N0°16'18"W 1042.22'**  
recorded as(S0°16'18"E 288.70')

2018.112

Sheet 1 of 1 Sheets

Job Reference Number  
**2018.112**

**Legend of Symbols & Abbreviations**

- Found County Section Corner
- Found Iron Pipe
- Set Iron Pipe, 1" dia.
- Recorded Information
- Utility Pole
- Utility Pedestal
- Concrete Cover
- Asphalt Surface
- Concrete Surface
- Gravel Surface
- Septic Vent
- North
- South
- East
- West
- In Bearings
- Degrees
- Minutes
- Seconds
- In Distances
- Feet
- Inches



45 South Wisconsin Street | P.O. Box 322  
Elkhorn, Wisconsin. 53121  
Telephone: (262) 723-3434  
Facsimile: (262) 723-8044  
Email: doug@olsonsurveying.com  
Website: www.olsonsurveying.com

Scale in Feet  
1" = 30'



Survey Date: November 7, 2018.  
Revisions: No. 1 - Proposed Building

BA1045-1  
215-811