

Plat of Survey

of

Lot 1 of Certified Survey Map No. 1045,

recorded in Vol. 5 of Certified Survey Maps of Walworth County on Page 14 and located in the Northwest 1/4 and the Southwest 1/4 of the Southeast 1/4 of Section 19, Town 2 North, Range 15 East, Town of Darien, Walworth County, Wisconsin.

Surveyed for: **Roger Millard**
N3387 North Road
Darien, Wisconsin. 53114

Tax Parcel
BD 1900007

Found pipe bent, dug down 1' until straight, straightened pipe & reset in that location.

recorded as (N89°53'42"E 271.20')
N89°54'23"E 271.46'
238.14'
238.46'
(238.20')

recorded as (N0°16'18"W 288.70')
N0°15'44"W 288.60'

Tax Parcel
BD 1900007

Lot 1
Tax Parcel
BA104500001

1.798 Acres
78,317 Sq.Ft.
1.579 Acres
68,794 Sq.Ft.
Exclusive of R.O.W.

Edge of Farm Field

Edge of Farm Field

Edge of Farm Field

Edge of Farm Field

Tax Parcel
BD 1900007

Found pipe bent, dug down 1' until straight, set new pipe in that location.

(238.20')
238.30'
238.18'
S89°54'08"W 271.30'
recorded as (S89°53'42"W 271.20')

Copyright © 2018 by Olson Land Surveying, LLC.

All rights reserved. No part of this survey plat may be reproduced or transmitted in any form by any means - graphic, electronic, or mechanical, including photocopying, tracing, or information storage and retrieval systems - without permission in writing from Douglas G. Olson, Olson Land Surveying, LLC.

I hereby certify that I have surveyed the above described property in compliance with Chapter A-E 7 of the Wisconsin Administrative Code and that the map hereon is correct to the best of my professional knowledge and belief and shows the size and location of the property, its exterior boundaries, the location and dimensions of all visible structures thereon, boundary fences, apparent easements and roadways and visible encroachments, if any.

This survey is made for the exclusive use of the present owners of the property, and also those who purchase, mortgage or guarantee title thereto, within one year from the date hereof.

Douglas G. Olson
Wisconsin Professional Land Surveyor - 2093

South 1/4 Corner
Section 19-2-15
(N. 224,486.75)
(E. 2,332,022.94)

recorded as (S88°45'05"W 2641.99') State Plane
S89°48'01"W 2642.08'

Southeast Corner
Section 19-2-15
(N. 224,544.32)
(E. 2,334,864.25)

1322.35'

1322.35'

N89°51'45"E 2644.70'
recorded as (N88°49'05"E 2644.61') State Plane

East 1/4 Corner
Section 19-2-15
(N. 227,187.55)
(E. 2,334,606.54)

Center 1/4 Corner
Section 19-2-15
(N. 227,133.00)
(E. 2,331,962.54)



Bearings referenced to the East line of Certified Survey Map No. 1045, recorded as N0°16'18"W, which produces a bearing of S89°48'01"W on the South line of the Southeast 1/4 of Section 19-2-15. A rotation of 1°02'56" from the Wisconsin State Plane Coordinate System, South Zone, (NAD-27).

Coordinates are referenced to the Wisconsin State Plane Coordinate System, South Zone, (NAD-27).

North Road

(66' Wide)

Tax Parcel
BD 1900006

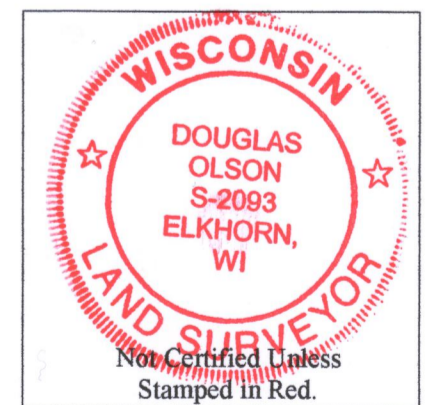

Notes:

- 1) This Plat of Survey is not certified unless signed and sealed in red ink.
- 2) This survey is subject to Wisconsin lien laws. This Plat of Survey is the notice of intent to file lien. Lien waiver required.
- 3) The Survey Date shown on this Plat of Survey is the completion date of the field work.

2018.112

Sheet 1 of 1 Sheets

Drawing Name:

Job Reference Number
2018.112

Legend of Symbols & Abbreviations

- Found County Section Corner
- Found Iron Pipe
- Set Iron Pipe, 1" dia.
- Recorded Information
- Utility Pole
- Utility Pedestal
- Concrete Cover
- Asphalt Surface
- Concrete Surface
- Septic Vent
- Gravel Surface
- N North
- S South
- E East
- W West
- In Bearings
- ° Degrees
- ' Minutes
- " Seconds
- In Distances
- Feet
- Inches



45 South Wisconsin Street | P.O. Box 322
Elkhorn, Wisconsin. 53121
Telephone: (262) 723-3434
Facsimile: (262) 723-8044
Email: doug@olsonsurveying.com
Website: www.olsonsurveying.com

Scale in Feet
1" = 30'



Survey Date: November 7, 2018.

Revisions:

BA1045-1
215-810