

Plat of Survey

of
Lot 1 of a Proposed Certified Survey Map,
 being part of Tax Parcel B D 200003, located in the Northwest 1/4 of Section 2,
 Town 2 North, Range 15 East, Town of Darien, Walworth County, Wisconsin.

Surveyed for: **Cary Scott**
 W8087 R & D Townline Road
 Delavan, Wisconsin. 53115

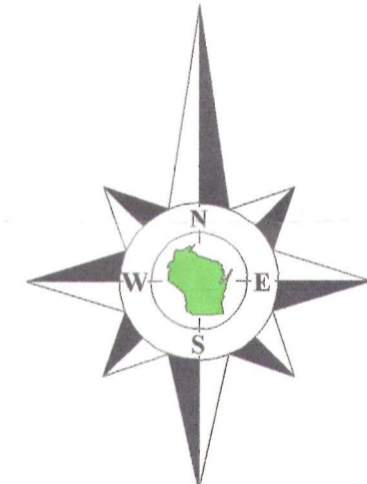

Bearings reference to the Wisconsin State
 Plane Coordinate System, South Zone.

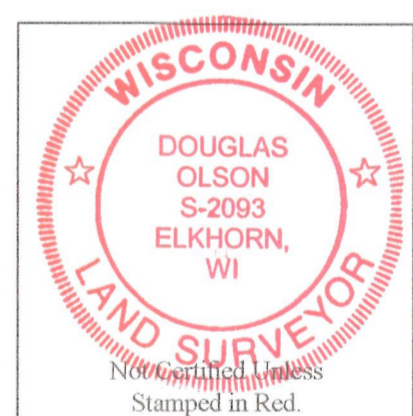

- Notes:**
- 1) This survey plat is not certified unless signed and sealed in red ink.
 - 2) This survey is subject to Wisconsin lien laws. This Plat of Survey is the notice of intent to file lien. Lien waiver required.

I, Douglas G. Olson, Wisconsin Registered Land Surveyor, do hereby certify that this survey was performed by me, or under my direction in full compliance with the owner's/agent's instructions and Chapter A-E 7 of the Wisconsin Administrative Code "Minimum Standards for Property Surveys", and that this map is an accurate representation thereof to the best of my knowledge and belief.

Douglas G. Olson
 Wisconsin Registered Land Surveyor - 2093

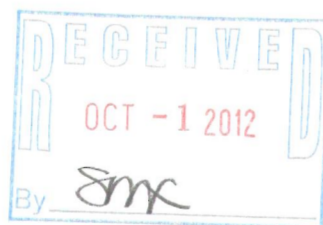

Copyright 2012 by Jensen & Olson Land Surveying, LLC.
 All rights reserved. No part of this survey plat may be reproduced or transmitted in any form by any means - graphic, electronic, or mechanical, including photocopying, tracing, or information storage and retrieval systems - without permission in writing from Douglas G. Olson, Jensen & Olson Land Surveying, LLC.

Survey Date: February 3, 2012.
 Revisions:

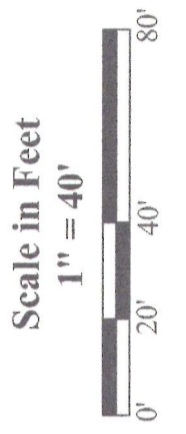

Jensen & Olson Land Surveying, LLC
 45 South Wisconsin Street * P.O. Box 322 * Elkhorn, Wisconsin. 53121
 Telephone: (262) 723-3434 * Facsimile: (262) 723-8044
 Email: jensen.olson@elknet.net

- Legend**
- Found County Section Corner
 - Set Iron Pipe
 - Recorded Information
 - Utility Pole
 - Concrete Cover
 - Asphalt Surface
 - Concrete Surface
 - Gravel Surface
 - Non-Certified Unless Stamped in Red.

Sheet 1 of 1 Sheets
 Job Reference Number
2012.004

2012.004

Tax Parcel
 B D 300001

Tax Parcel

B D 200003
 (Approx. 154.76 Acres)

BA 4416-1

2/5 - 730