

Tax Parcel
BD 700006

Plat of Survey

of

Lot 2 of Certified Survey Map No. 3850,

recorded in Vol. 23 of Certified Survey Maps of Walworth County on Page 201 and located in the Southeast 1/4 of Section 7, Town 2 North, Range 15 East, Town of Darien, Walworth County, Wisconsin.

Surveyed for: **Peter & Elizabeth Hiemstra**

W9348 Christie Road
Darien, Wisconsin. 53114.

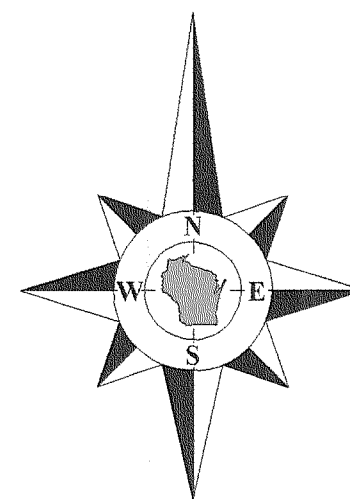

Bearings reference to the Wisconsin State Plane Coordinate System, South Zone.

Location Sketch

Section 7,
Town 2 North, Range 15 East
1"=3000'

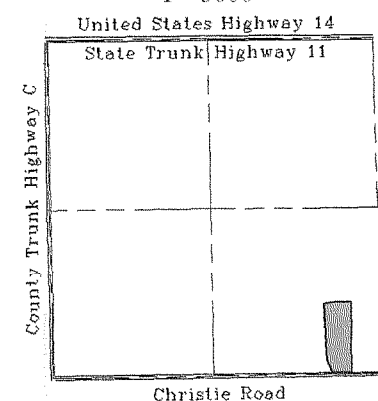

Tax Parcel
BD 700006

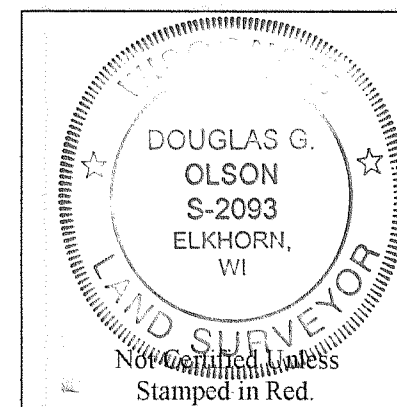
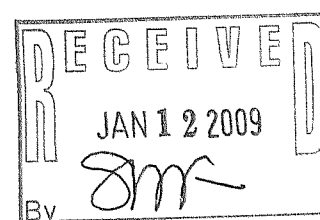

Notes:

- 1) This survey plat is not certified unless signed and sealed in red ink.
- 2) This survey is subject to Wisconsin lien laws. This Plat of Survey is the notice of intent to file lien. Lien waiver required.

Copyright 2008 by Jensen & Olson Land Surveying, LLC.

All rights reserved. No part of this survey plat may be reproduced or transmitted in any form by any means - graphic, electronic, or mechanical, including photocopying, tracing, or information storage and retrieval systems - without permission in writing from Douglas G. Olson, Jensen & Olson Land Surveying, LLC.

I hereby certify that I have surveyed the above described property and the map hereon is correct to the best of my professional knowledge and belief and shows the size and location of the property, its exterior boundaries, the location and dimensions of all visible structures thereon, boundary fences, apparent easements and roadways and visible encroachments, if any.

This survey is made for the exclusive use of the present owners of the property, and also those who purchase, mortgage or guarantee title thereto, within one year from the date hereof.

Douglas G. Olson
Wisconsin Registered Land Surveyor - 2093

South 1/4 Corner
Section 7-2-15.
N. 235,049.21
E. 2,331,770.26

South line of the Southeast 1/4 of Section 7-2-15.
S89°04'43"W 2655.12'

Southeast Corner
Section 7-2-15.
N. 235,091.90
E. 2,334,424.99

Christie Road (66' Wide)

Lot 1
C.S.M. 2319

N4°03'14"W 631.53'
Fence along line

N79°57'15"E 194.98'

N88°59'48"E 238.12'

Lot 2
10.118 Acres
440,761 Sq.Ft.

1108.39'
S1°24'11"E 1145.05'

Lot 1
C.S.M. 3850

N4°03'14"W 260.00'
130.00'

N28°10'18"W 168.161'
N4°03'14"W 20.00'
N28°10'18"W 168.161'
N4°03'14"W 20.00'

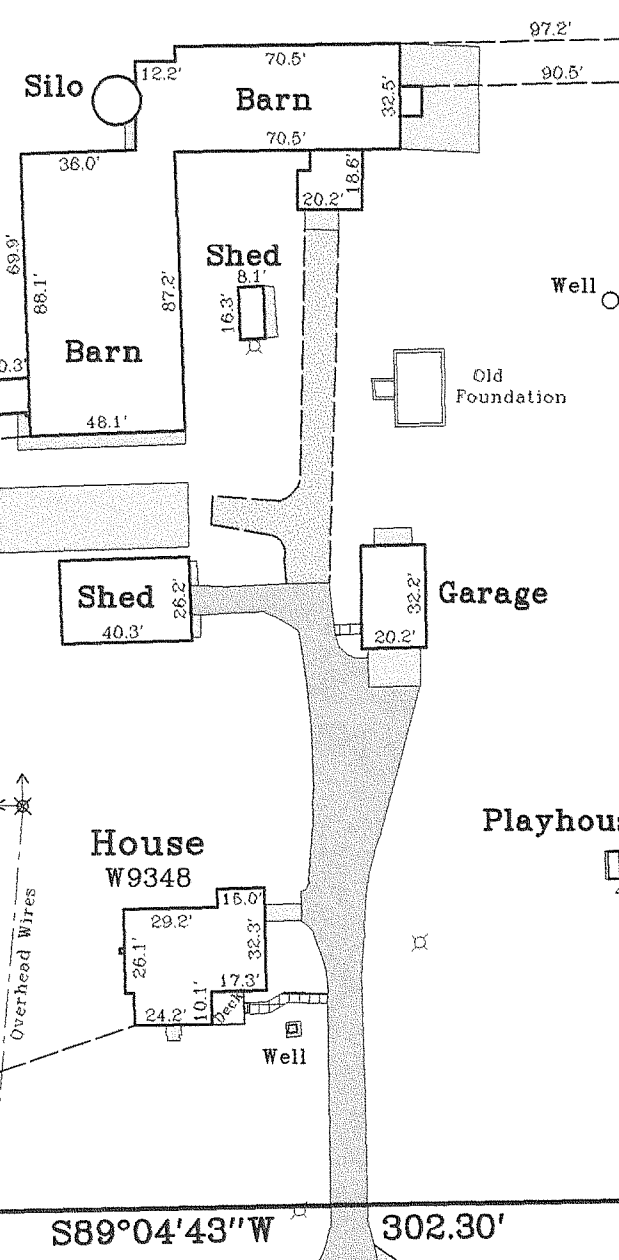

Overhead Wires

2008.088
Sheet 1 of 1 Sheets
Drawing Name: t2nr15e-2008088-2008088.sj
Job Reference Number
2008.088

Legend	
■	Found County Section Corner
○	Found Iron Pipe
○	Found Iron Rod
○	Found 4" dia. Metal fence corner post in concrete
()	Recorded information
⊗	Utility Pole
⊗	Pedestal
⊗	Asphalt Surface
⊗	Light Pole
⊗	Concrete Surface
⊗	Gravel

Jensen & Olson Land Surveying, LLC
45 South Wisconsin Street * P.O. Box 322 * Elkhorn, Wisconsin. 53121
Telephone: (262) 723-3434 * Facsimile: (262) 723-8044
Email: jensen.olson@elknet.net

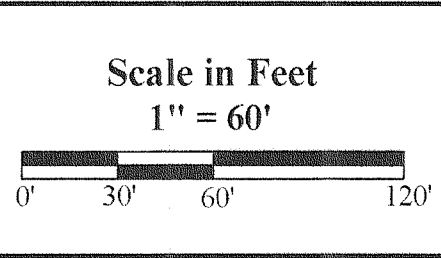

Survey Date: July 2, 2008.
Revisions:

BA3850-2

215-688