

DUNHAM & RASMUSSEN
SURVEYING & ENGINEERING
DELAVER, WISCONSIN

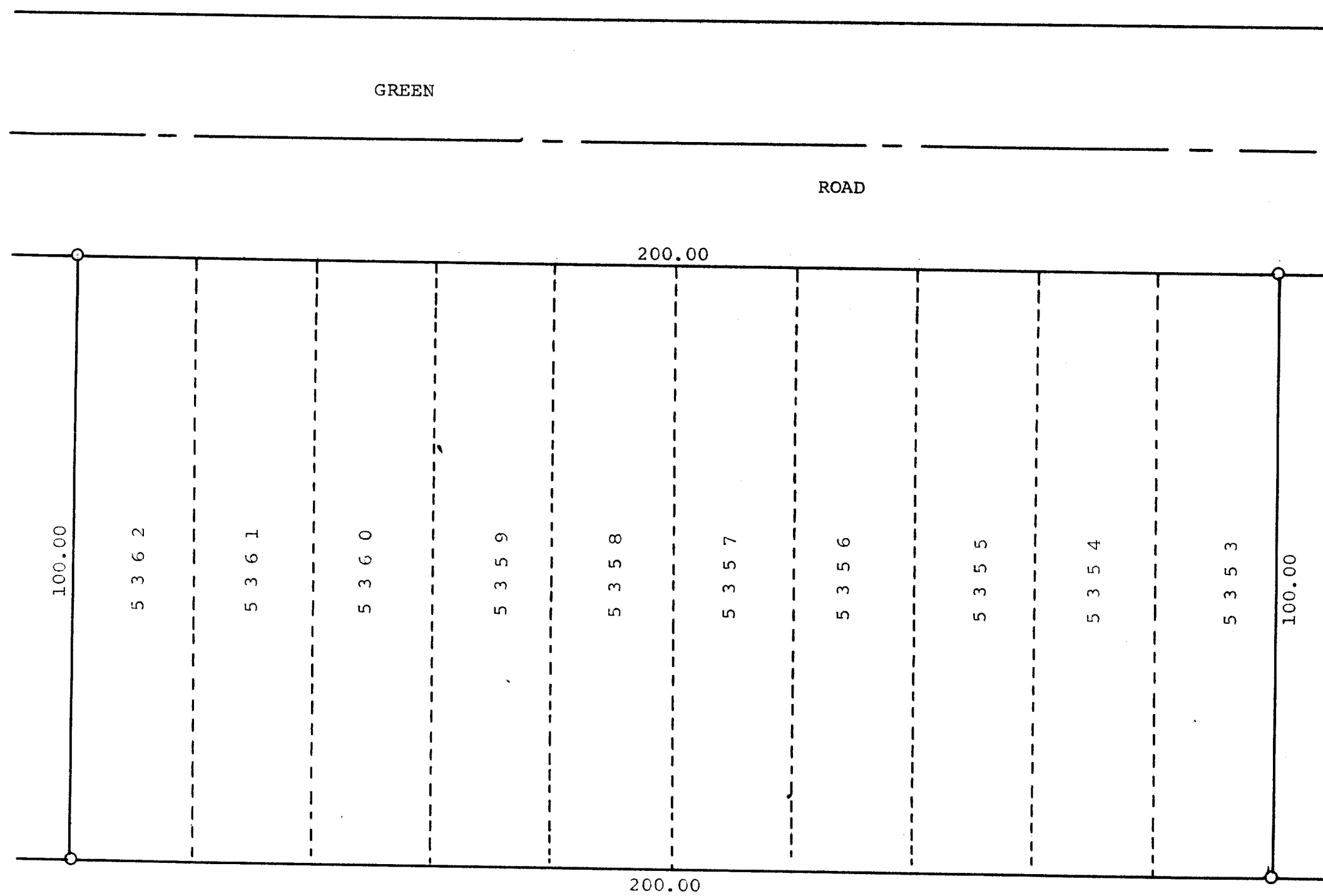

SCALE--1"=20'
○ = IRON PIPE

Plat of survey of Lots 5353-5362 Inclusive in Block 99, Section 3
of Bell Lake Subdivision, Town of Bloomfield, Walworth County, Wisconsin
October 1961

Scott J. Dunham

118-69