

PLAT OF SURVEY OF

LOTS 412, 416, 444-451, BLOCK 9, PELL LAKE SUBDIVISION,  
PELL LAKE, WALWORTH COUNTY, WISCONSIN.

LEGEND

- LOT LINES AS PLATTED
- - - OCCUPATION LINES
- ( ) AS PLATTED
- Ø IRON PIPE FOUND
- o IRON PIPE PLACED

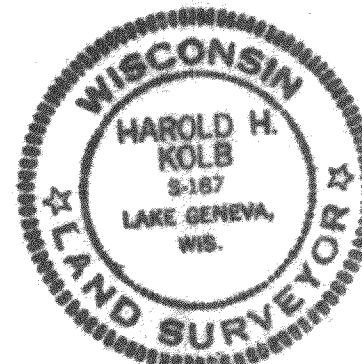

I, HAROLD H. KOLB, DO HEREBY CERTIFY THAT I HAVE SURVEYED THE PROPERTY HEREON DESCRIBED ACCORDING TO THE OFFICIAL RECORDS, AND THAT THE PLAT HEREON IS A CORRECT REPRESENTATION OF THE LOT LINES TO THE BEST OF MY KNOWLEDGE AND BELIEF.

*Harold H. Kolb*  
HAROLD H. KOLB  
WISCONSIN REGISTERED LAND SURVEYOR, S-187

DATE: June 14, 1979

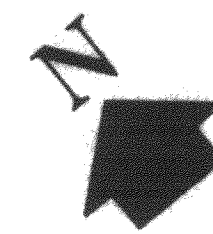

SCALE : 1" = 50'

MPL 90  
93