

## of

recorded July 16, 1924 in Vol. 7 of Plats of Walworth County on Page 152 as Document Number C003S077 and located in the Northwest 1/4 of the Northwest 1/4 of Section 22, Town 1 North, Range 18 East, Village of Bloomfield, Walworth County, Wisconsin.

Surveyed for: **Jeffery Kuester**  
P.O. Box 841  
Pell Lake, Wisconsin. 53157

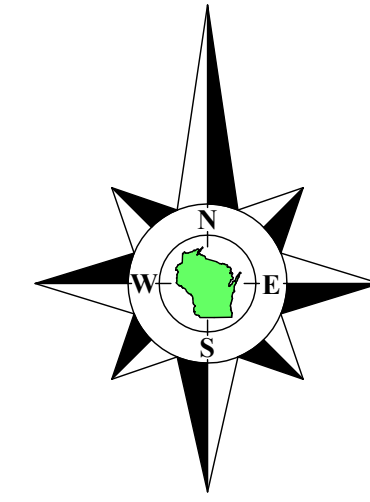

Bearings referenced to the West line of the Northwest 1/4 of Section 22-1-18, recorded as N1°33'13"W in the Wisconsin State Plane Coordinate System, South Zone, (NAD-27).

Coordinates are referenced to the Wisconsin State Plane Coordinate System, South Zone, (NAD-27).

Revisions:  
Survey Date: May 2, 2024.

**Scale in Feet**  
**1" = 20'**



A horizontal graphic scale bar with alternating black and white segments. The segments are labeled from left to right: 0', 10', 20', 40', and 60'.

45 South Wisconsin Street | P.O. Box 322  
Elkhorn, Wisconsin. 53121  
Telephone: (262) 723-3434  
Facsimile: (262) 723-8044  
Email: [doug@olsonsurveying.com](mailto:doug@olsonsurveying.com)  
Website: [www.olsonsurveying.com](http://www.olsonsurveying.com)

**OLSON**  
LAND SURVEYING, LLC  
Rural | Residential | Commercial

Legend of Symbols & Abbreviations		N	North
Found	County Section Corner	N <td>North</td>	North
Found	Iron Pipe	S <td>South</td>	South
Found	Iron Rod	E <td>East</td>	East
Found	Iron Nail	W <td>West</td>	West
Recorded	Information		In Bearings
Utility Pole	Hydrant		Degrees
Utility Pedestal			Minutes
Water Valve			Seconds
Manhole			In Distances
Asphalt Surface			Feet
Gravel Surface			Inches
Concrete Surface			
Brick Pavers			

<b>Sheet 1 of 1 Sheets</b>	Drawing Name:	<b>Job Reference Number 2024.028</b>
<b>2024.028</b>		

Northwest Corner  
Section 22-1-18  
N. 200,449.41  
E. 2,440,979.68

recorded as N1°33'13"W 2649.20' State Plane  
N1°33'13"W 2649.28'

West 1/4 Corner  
Section 22-1-18  
N. 197,801.17  
E. 2,441,051.51

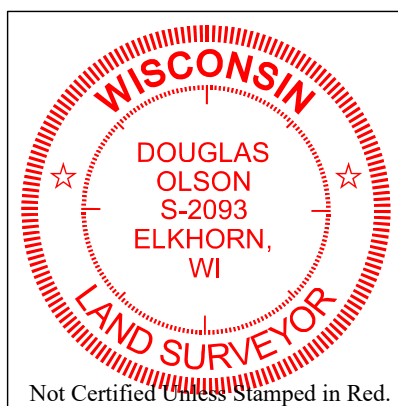

**Notes:**

- 1) This Plat of Survey is not certified unless signed and sealed in red ink.
- 2) This survey is subject to Wisconsin lien laws. This Plat of Survey is the notice of intent to file lien. Lien waiver required.
- 3) The Survey Date shown on this Plat of Survey is the completion date of the field work.

Copyright © 2024 by Olson Land Surveying, LLC.

All rights reserved. No part of this survey plat may be reproduced or transmitted in any form by any means - graphic, electronic, or mechanical, including photocopying, tracing, or information storage and retrieval systems - without permission in writing from Douglas G. Olson, Olson Land Surveying, LLC.

I hereby certify that I have surveyed the above described property in compliance with Chapter A-E 7 of the Wisconsin Administrative Code and that the map hereon is correct to the best of my professional knowledge and belief and shows the size and location of the property, its exterior boundaries, the location and dimensions of all visible structures thereon, boundary fences, apparent easements and roadways and visible encroachments, if any.

This survey is made for the exclusive use of the present owners of the property, and also those who purchase, mortgage or guarantee title thereto, within one year from the date hereof.

Douglas G. Olson  
Wisconsin Professional Land Surveyor - 2093