

PLAT OF SURVEY

LEGAL DESCRIPTION:
A PARCEL OF LAND LOCATED IN THE SOUTHWEST 1/4 AND THE SOUTHEAST 1/4 OF THE NORTHWEST 1/4 OF SECTION 3 IN TOWNSHIP 1 NORTH, RANGE 18 EAST, IN THE TOWN OF BLOOMFIELD, WALWORTH COUNTY, WISCONSIN.

MORE PARTICULARLY DESCRIBED AS:
LOT 6 OF TUSCANY OF LAKE GENEVA AS RECORDED IN DOCUMENT No. 239963, CABINET B, SLIDE 122 PER THE WALWORTH COUNTY REGISTER OF DEEDS.

NOTE:
PROPOSED SEPTIC AREA PER SOIL EVALUATION REPORT BY ORIGINAL ASSOCIATES SOIL TESTING DATED 05/11/2023

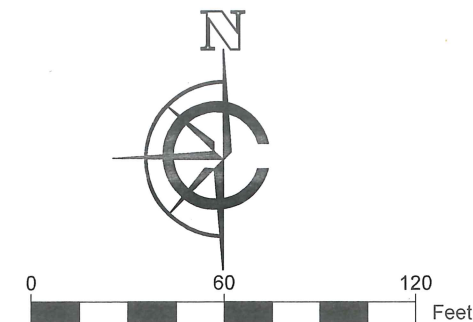

SCALE: 1" = 60'
SHEET SIZE: 11"X17"

- LEGEND**
- FOUND 1" IRON PIPE
 - FOUND IRON ROD
 - (XX) RECORDED AS
 - ⊗ SOIL BORING
 - ▬ PROPOSED BUILDING
 - ▬ PROPOSED ASPHALT
 - UTILITY POLE
 - FOUND ELECTRIC PEDESTAL
 - ▭ FOUND CULVERT / INVERT
 - ▬ PROPOSED SEPTIC FIELD
 - TUG — UNDERGROUND TELEPHONE
 - EUG — UNDERGROUND ELECTRIC
 - 905 — MAJOR CONTOURS (Increments of 5)
 - 901 — MINOR CONTOURS (Increments of 1)

BASIS OF BEARING:
THE WISCONSIN STATE PLANE COORDINATE SYSTEM, NAD-83, SOUTH ZONE.

BASIS OF ELEVATION:
ELEVATIONS ARE REFERENCED TO THE NORTH AMERICAN VERTICAL DATUM OF 1988 ("NAD88")

UTILITIES:
UNDERGROUND UTILITIES ARE SURVEYED AND SHOWN PER DIGGERS HOTLINE FIELD LOCATIONS

SURVEY ORDERED BY:
ANDY BACKUS

PROPERTY ADDRESS:
SIENA CIRCLE
BLOOMFIELD WI, 53128

FIELD WORK COMPLETED ON:
MAY 10, 2023
FIELD CREW CHIEF:
TODD HENRICKSEN

SURVEYOR:
PAUL H. VAN HENKELUM, PLS
CARDINAL ENGINEERING LLC

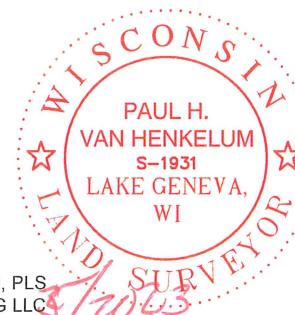

"I HEREBY CERTIFY THAT I HAVE SURVEYED THE ABOVE DESCRIBED PROPERTY AND THE MAP IS A TRUE AND CORRECT REPRESENTATION OF ITS EXTERIOR BOUNDARIES AND SHOWS THE SIZE AND LOCATION OF ALL VISIBLE STRUCTURES, APPARENT EASEMENTS AND ENCROACHMENTS, IF ANY."

Paul H. Van Henkelum
PAUL H VAN HENKELUM, PLS #1931

5/18/2023
DATE



CARDINAL
PLAN | SURVEY | ENGINEER

1200 LA SALLE ST.
LAKE GENEVA, WI 53147
262-757-8776
PLANSURVEYENGINEER.COM

DATE: 07 / 12 / 2022
SHEET 1 OF 1

JOB No. 22366
LWG