

PLAT OF SURVEY
-OF-

LOT 3 OF "HEARTLAND SUBDIVISION", LOCATED IN THE NORTHWEST 1/4 OF THE NORTHEAST 1/4 OF SECTION 16, TOWNSHIP 1 NORTH, RANGE 18 EAST OF THE FOURTH PRINCIPAL MERIDIAN, IN THE VILLAGE OF BLOOMFIELD, COUNTY OF WALWORTH AND STATE OF WISCONSIN.

SURVEY FOR: GENO FALLETTI

CURVE DATA

C1

RADIUS = 317.00'
CENTRAL ANGLE = 20°55'40"
CHORD = 115.14'
CHORD BEARING = S16°41'26"W

C2

RADIUS = 60.00'
CENTRAL ANGLE = 126°38'28"
CHORD = 107.22'
CHORD BEARING = S20°28'01"W

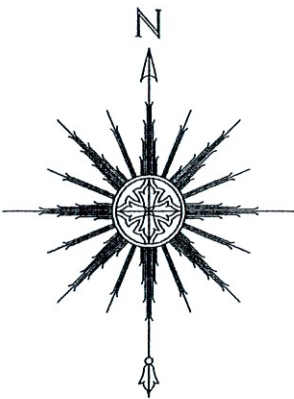

0 30' 60' 120'
SCALE: 1" = 60'

SATTER SURVEYING, LLC
LAND SURVEYS, MAPPING AND PLANNING
272 ORIGEN STREET
BURLINGTON, WI 53105
262-661-4239

THIS MAP IS BEING REVISED THIS 10TH DAY OF JULY, 2020 TO DEPICT THE EXISTING DWELLING AND CONCRETE SLAB AND SHOW THEIR PROXIMITY TO THE PROPERTY LINES. ALL OTHER PROPERTY DETAILS ARE FROM PREVIOUS SURVEY WORK DATED FEBRUARY 28, 2020 AND WERE NOT RE-VERIFIED AS PART OF THIS UPDATED SURVEY.

LOT 3
5.00 acres

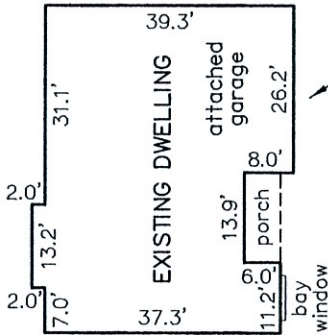

SEE DWELLING DETAIL
DETAIL SCALE: 1" = 30'

Dwelling is 0.8' westerly of the minimum street yard setback. Bay window is 0.4' west of said setback.

LEGEND

- ⊙ FOUND 1-3/16" DIA. IRON ROD
- FOUND 3/4" DIA. IRON ROD

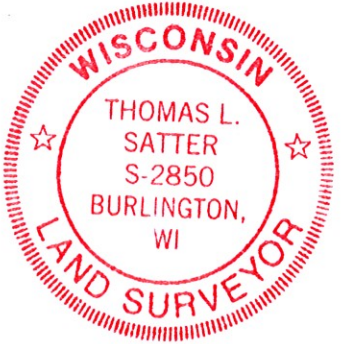

THIS IS NOT AN ORIGINAL PRINT
UNLESS THIS SEAL IS RED.

Thomas L. Satter
THOMAS L. SATTER S-2850

REVISED: 7/10/20
FEBRUARY 28, 2020
DATE

022009
JOB NUMBER

"I HEREBY CERTIFY THAT I HAVE SURVEYED THE ABOVE DESCRIBED PROPERTY AND THAT THE ABOVE MAP IS A CORRECT REPRESENTATION THEREOF AND SHOWS THE SIZE AND LOCATION OF THE PROPERTY, ITS EXTERIOR BOUNDARIES, THE LOCATION OF ALL VISIBLE STRUCTURES AND DIMENSIONS OF ALL PRINCIPAL BUILDINGS THEREON, BOUNDARY FENCES, APPARENT EASEMENTS, ROADWAYS AND ENCROACHMENTS, IF ANY."

"THIS SURVEY IS MADE FOR THE USE OF THE PRESENT OWNERS OF THE PROPERTY, AND THOSE WHO PURCHASE, MORTGAGE, OR GUARANTEE THE TITLE THERETO WITHIN ONE YEAR FROM DATE HEREOF."

