

PREPARED FOR  
BASSO BUILDERS  
403 SKYLINE DR.  
LAKE GENEVA WI. 53147

KROTT SURVEYING INC.

N3705 WILLOW BEND LANE  
LAKE GENEVA WI. 53147  
PHONE # (262)248-3697  
FAX # (262)249-0639

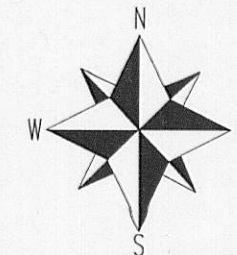

SCALE 1"=20'

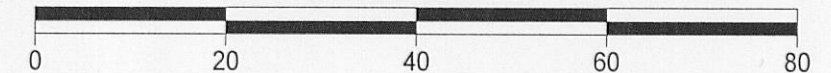

I have surveyed the above-described property and the above map is a true representation thereof and shows the size and location of the property, its exterior boundaries, the location and dimensions of all structures thereon, fences apparent easements and roadways and visible encroachments, if any.

This survey is made for the exclusive use of the present owners of the property, and also those who purchase, mortgage, or insure the title thereto within one (1) year from date hereof; and as to them I warrant the accuracy of said survey map.

NOTE: BEARINGS ARE REFERENCED TO THE RECORD PLAT.

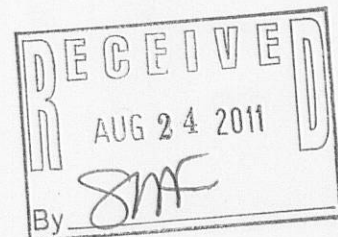

## PLAT OF SURVEY

-OF-

LOT 10 OF Wm ELLIOTT'S POWERS LAKE SUBDIVISION, ACCORDING TO THE RECORD PLAT THEREOF BEING A SUBDIVISION OF PART OF THE NORTHEAST FRACTIONAL 1/4 OF SECTION 13 TOWN 1 NORTH, RANGE 18 EAST, EXCEPTING THEREFROM THE FOLLOWING TO PARCELS, TO-WIT

(X-1) THAT PART THEREOF CONVEYED TO JOHN CLANCEY BY WARRANTY DEED DATED 9 OCTOBER, 1909, AND RECORDED 2 DECEMBER, 1909 IN WALWORTH COUNTY REGISTER'S OFFICE AS DOCUMENT NO. 196149, IN VOLUME 127 OF DEEDS ON PAGE 76 DESCRIBED AS FOLLOWS: BEGINNING AT THE NORTHWEST CORNER OF SAID LOT 10; THENCE EASTERLY ON THE NORTH LINE OF SAID LOT 10, 80 FEET; THENCE SOUTHERLY PARALLEL WITH ELLIOTT AVENUE 11 FEET; THENCE WESTERLY PARALLEL WITH THE NORTH LINE OF SAID LOT 10, 80 FEET TO ELLIOTT AVENUE; THENCE NORTHERLY ALONG SAID ELLIOTT AVENUE; 11 FEET TO THE PLACE OF BEGINNING; AND

(X-2) THAT PART THEREOF CONVEYED TO C.W. REED BY QUIT CLAIM DEED DATED 13 APRIL, 1943, RECORDED 1 MAY, 1943, IN WALWORTH COUNTY REGISTER'S OFFICE AS DOCUMENT NO. 361155 IN VOLUME 301 OF DEEDS ON PAGE 387 DESCRIBED AS FOLLOWS: COMMENCING AT THE NORTHWESTERLY CORNER OF SAID LOT 10; THENCE SOUTHEASTERLY ALONG THE NORTHERLY LINE THEREOF, 80 FEET TO THE PLACE OF BEGINNING; THENCE SOUTHWESTERLY PARALLEL WITH THE WESTERLY LINE OF SAID LOT 10, 11 FEET; THENCE EASTERLY 22.32 FEET TO A POINT IN THE NORTHWESTERLY LINE OF SAID LOT 10 WHICH IS 20 FEET SOUTHEASTERLY FROM THE PLACE OF BEGINNING; THENCE NORTHWESTERLY ALONG THE NORTHERLY LINE OF SAID LOT 10, 20 FEET TO THE PLACE OF BEGINNING. SAID LAND LYING AND BEING IN THE TOWN OF BLOOMFIELD, COUNTY OF WALWORTH, STATE OF WISCONSIN.

### LEGEND

- FOUND IRON PIPE
- ⊕ FOUND CUT CROSS
- ⊗ UTILITY POLE
- OVERHEAD WIRES
- ⊙ WELL

(XX) RECORDED AS

TAX ID # ME00010

JOB # 11-102

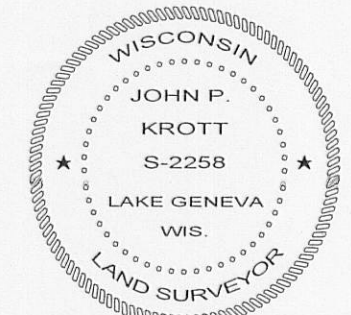

DATED THIS 8th DAY OF JULY 2011.  
DATE OF LAST REVISION 08/08/2011

JOHN KROTT S - 2258  
Wisconsin Registered Land Surveyor  
(original if signed in red)

118-3081