

## of

located in the Northeast 1/4 of Section 16, Town 1 North,  
Range 18 East, Town of Bloomfield, Walworth County, Wisconsin.

RECEIVED  
DEC - 5 2006  
SMF

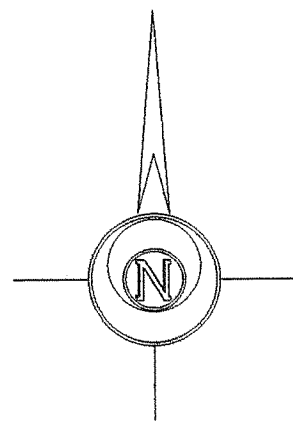

Bearings reference to the plat of Heartland Subdivision.

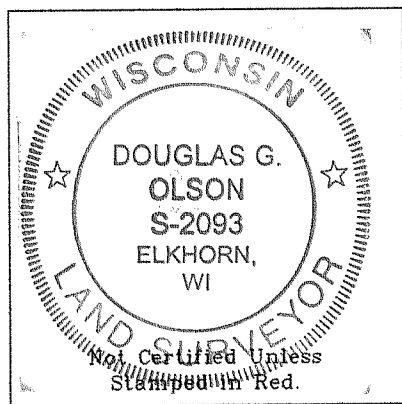
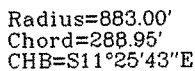

Copyright c 2006 by Jensen & Olson Land Surveying, LLC.

All rights reserved. No part of this survey plat may be reproduced or transmitted in any form by any means - graphic, electronic, or mechanical, including photocopying, tracing, or information storage and retrieval systems - without permission in writing from Douglas G. Olson, Jensen & Olson Land Surveying, LLC.

I hereby certify that I have surveyed the above described property and the map hereon is correct to the best of my professional knowledge and belief and shows the size and location of the property, its exterior boundaries, the location and dimensions of all visible structures thereon, boundary fences, apparent easements and roadways and visible encroachments, if any.

This survey is made for the exclusive use of the present owners of property, and also those who purchase, mortgage or guarantee title thereto, within one year from the date hereof.

Douglas G. Olson  
Wisconsin Registered Land Surveyor - 2093

Notes:

- 1) This survey plat is not certified unless signed and sealed in red ink.
- 2) This survey is subject to Wisconsin lien laws. This Plat of Survey is the notice of intent to file lien. Lien waiver required.

### Legend

- Found Iron Rod, 1-3/16" dia.
- Found Iron Rod, 3/4" dia.
- Ø Found Iron Pipe
- ( ) Recorded Information
- ☒ Utility Box or Pedestal
- ☒ Gas Sign
- Asphalt Surface

Jensen & Olson Land Surveying, LLC

45 South Wisconsin Street P.O. Box 322  
Elkhorn, Wisconsin. 53121  
Telephone: (262) 723-3434  
Facsimile: (262) 723-8044

Scale: 1" = 100'

Survey date: October 29, 2004.

Revisions: No. 1 - Proposed Hse  
No. 2 - Foundation

Sheet 1 of 1 Sheets.

Job Reference Number:

MHE - 1



118-2772 2006.028