

LAND-MARK SURVEYING

Mark L. Miritz

Wisconsin Registered Land Surveyor S-2582

N9330 Knuteson Drive
Whitewater, WI 53190
Phone: (262) 495-3284
FAX : (262) 495-8421
LAND-MARKSURVEYING.COM

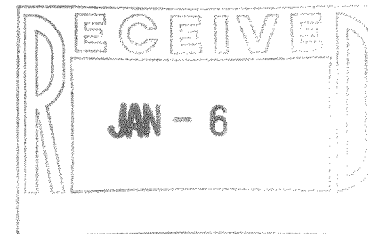

ORDERED BY:
SCHAUDER BUILDING, INC.
4115 U.S. HIGHWAY 51 NORTH
JANESVILLE, WI 53545-9674

OWNERS: ROBERT & FRANCES HANEMAN

PLAT OF SURVEY

LOT 6, HEARTLAND SUBDIVISION, LOCATED IN
THE NW 1/4 OF THE NE 1/4 OF SECTION 16,
TOWN 1 NORTH, RANGE 18 EAST, BLOOMFIELD
TOWNSHIP, WALWORTH COUNTY, WISCONSIN.

LOT 7

N 78°04'10" E 644.73'

LOT 6

5.017 ACRES

PROPOSED RESIDENCE

LOT 5

REVISED DEC. 23, 2004 TO SHOW ELEVATIONS

NOTE:
WOOD STAKES HAVE BEEN PLACED AT THE BUILDING
CORNERS WITH 10' OFFSETS AS MARKED, BUILDER IS
TO VERIFY DIMENSIONS TO INSURE PROPER PLAN
INTERPRETATION AND CONTACT THIS OFFICE
IMMEDIATELY IF ANY DISCREPANCY EXISTS.

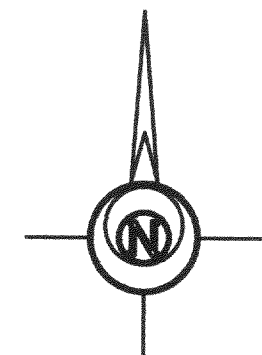

LEGEND

- ⊘ FOUND IRON PIPE
- FOUND IRON ROD
- ⊗ FOUND COUNTY MONUMENT
- FOUND CONCRETE MONUMENT
- + CHISEL CUT IN CONCRETE
- SET IRON ROD, 24" LONG, WEIGHING
1.5 LBS./LINEAL FT., 3/4" DIA.
- (x x) RECORDED AS DIMENSION
- x — EXISTING FENCE

ELEVATION

SCALE: 1" = 60 FEET

"I hereby certify that the above described property has
been surveyed by me or under my direction and that the
above map is a true representation thereof and shows the
size and location of the property, its exterior boundaries,
the location of all visible structures and dimensions of all
principal buildings thereon, boundary fences, apparent
easements, roadways and visible encroachments, if any."
"This survey is made for the use of the present owners of
the property, and also those who purchase, mortgage, or
guarantee the title thereto within one year from date
hereof."

Mark L. Miritz
MARK L. MIRITZ
WISCONSIN REGISTERED
LAND SURVEYOR S-2582

DATE: DEC. 12, 2004 JOB NO. 04.1206

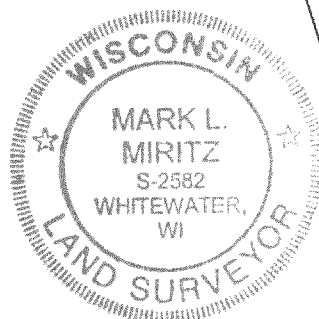

MHE-6

118-2517