

# TOPOGRAPHIC MAP

- of -

THE POOL COURTYARD AND ENTRY COURT PORTION OF THE PATRICK G. RYAN PROPERTY LOCATED IN THE WEST 1/2 OF SECTION 3, TOWN 1 NORTH, RANGE 17 EAST, TOWN OF LINN, WALWORTH COUNTY, WISCONSIN.

SURVEYED FOR: MORGAN WHEELOCK INC.  
286 CONGRESS STREET  
BOSTON, MASSACHUSETTS 02210

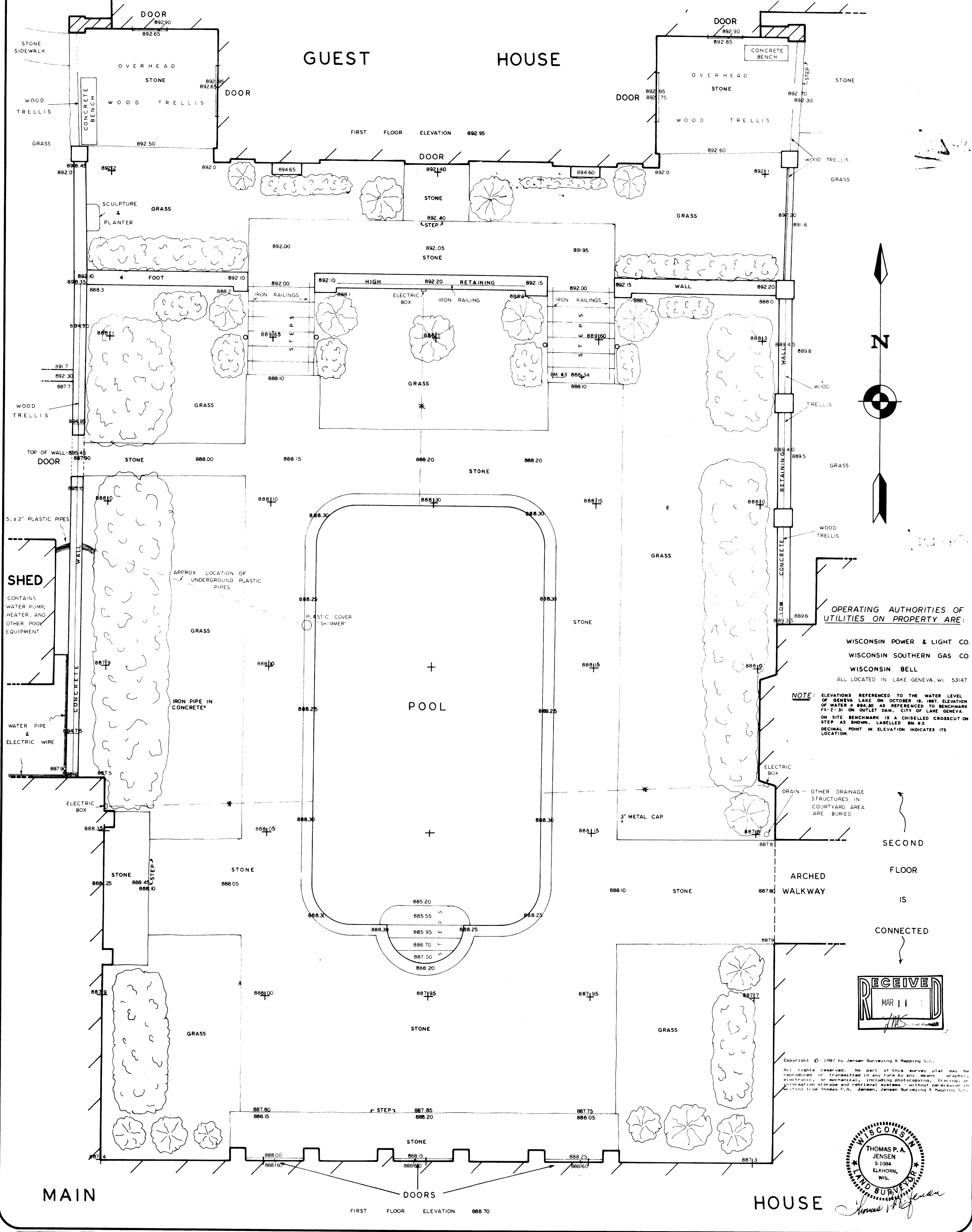

Sheet no. 1 of 3 sheets.  
Job reference number  
1987\_088

- Legend**
- ⊕ - GRID INTERSECTION
  - ⊗ - WATER VALVE & PIPE
  - - LIGHT
  - 🌿 - BUSH OR SHRUB
  - ⚡ - APPROX. LOCATION OF UNDERGROUND WIRES FOR POOL LIGHTS

**JENSEN SURVEYING & MAPPING S.C.**  
45 South Wisconsin Street P.O. Box 322  
Elkhorn, Wisconsin 53121  
(414) 723-3434

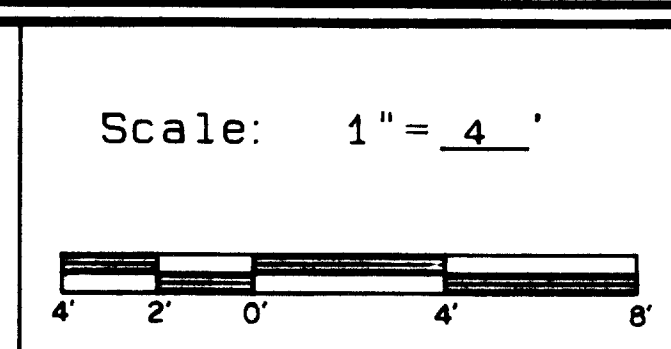

Mapping date: 10-23-87  
Revisions: NOV. 5, 1987

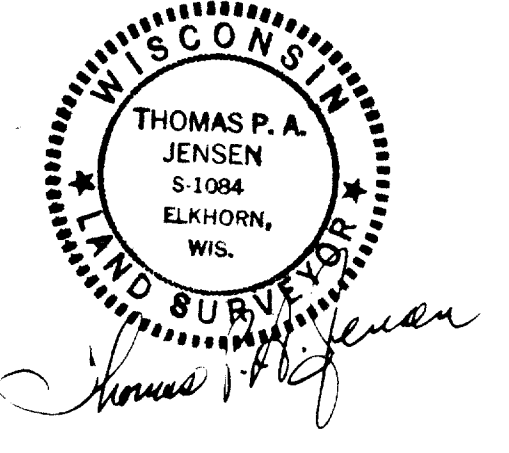

117-865

TAX KEY NO. IF-5

"THE FOLLY"

CONCRETE DRIVE

BM # 8  
ELEV. = 953.96

637.23

(N 0° 23' 20" E 839.20)

N 0° 23' 20" E

± 461.91  
376.88

N 0° 23' 20" E

± 650'

IRON RAIL AS SHOWN  
ON JOHN DEGEN  
SURVEY 1956

SHEED  
CONCRETE  
FOUNDATION

CONCRETE RETAINING WALLS

CONCRETE FOUNDATION

BARN

GARAGE

HOUSE

TENNIS  
COURT

SPECTATOR  
AREA

BRIDGE

GARDENS

TAX KEY NO. IF-5A

GRAVEL  
DRIVEWAY

GAZEBO

STONE WALK

CONCRETE DRIVEWAY

BRIDGE

DITCH

PLAYHOUSE

STONE WALK

GUEST  
HOUSE

COURTYARD

POOL  
ELEV. = 888.34

SEE SHEET I

SHED

MAIN  
HOUSE

WALK

STONE  
TERRACE

STEPS

STONE WALK

BM # 2  
ELEV. = 874.71

N 82° 17' 12" E 656.29

APPROX. 678' OF SHORELINE

LAKE

GENEVA

EAST WEST OF LOT 2 OF MALLORYS SPRING SUBDIVISION 2029.31

N 0° 24' 35" E  
± 2053.7'  
(N 0° 24' 35" E 2083.19' - BETWEEN STONE MONUMENTS)

STONE MONUMENT AS SHOWN ON  
JOHN DEGEN SURVEY 1956.

