

LAKE — (25' WIDE) — **VIEW** — **LANE**

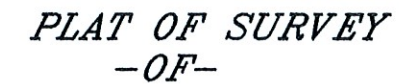

SURVEY FOR: SUNSET HILLS ASSOCIATION

NOTE: REFER TO A CURRENT TITLE REPORT
FOR EASEMENTS, RESTRICTIONS OR COVENANTS
WHICH MAY AFFECT THIS PROPERTY.

- FOUND 1-5/16" O.D. IRON PIPE
- ◊ FOUND 1-3/4" O.D. IRON PIPE
- FOUND 3/4" DIA. IRON ROD
- () RECORDED AS



THIS IS NOT AN ORIGINAL PRINT
UNLESS THIS SEAL IS RED.

Thomas L. Satter

JANUARY 10, 2025
DATE

102411
JOB NUMBER

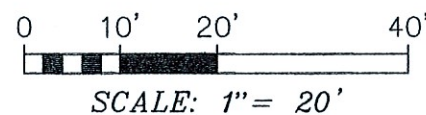

"I HEREBY CERTIFY THAT I HAVE SURVEYED THE ABOVE DESCRIBED PROPERTY AND THAT THE ABOVE MAP IS A CORRECT REPRESENTATION THEREOF AND SHOWS THE SIZE AND LOCATION OF THE PROPERTY, ITS EXTERIOR BOUNDARIES, THE LOCATION OF ALL VISIBLE STRUCTURES AND DIMENSIONS OF ALL PRINCIPAL BUILDINGS THEREON, BOUNDARY FENCES, APPARENT EASEMENTS, ROADWAYS AND ENCROACHMENTS, IF ANY."

"THIS SURVEY IS MADE FOR THE USE OF THE PRESENT OWNERS OF THE PROPERTY, AND THOSE WHO PURCHASE, MORTGAGE, OR GUARANTEE THE TITLE THERETO WITHIN ONE YEAR FROM DATE HEREOF."

SATTER SURVEYING, LLC
LAND SURVEYS, MAPPING AND PLANNING
272 ORIGIN STREET
BURLINGTON, WI 53105
262-661-4239