

South Lakeshore Drive

recorded as(N88°37'10"E 2839.55')State Plane
S89°31'25"E 2839.21'
North line of the Southwest 1/4 of Section 17-1-17

Center 1/4 Corner
Section 17-1-17
(N. 202,413.08)
(E. 2,401,598.31)

Plat of Survey

of

Lot 2 of Certified Survey Map No. 3018,

recorded September 2, 1998 in Vol. 16 of Certified Survey Maps of Walworth County on Page 109 as Document Number 392009 and located in the Northwest 1/4 of the Southwest 1/4 of Section 17, Town 1 North, Range 17 East, Town of Linn, Walworth County, Wisconsin.

Surveyed for: **RE/Max Plaza**
101 Broad Street
Lake Geneva, Wisconsin. 53147

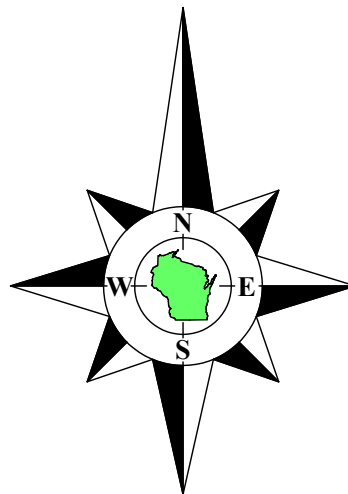

Bearings referenced to the West line of Certified Survey Map No. 3018, recorded as N0°28'15"E, which produces a bearing of S89°31'25"E on the North line of the Southwest 1/4 of Section 17-1-17. A rotation of 1°32'05" from the Wisconsin State Plane Coordinate System, South Zone, (NAD-27).

Coordinates are referenced to the Wisconsin State Plane Coordinate System, South Zone, (NAD-27).

Lot 1
C.S.M. 3018

50' Wide Easement For Ingress and Egress
As Shown on Certified Survey Map No. 3018

recorded as(N89°28'10"E 330.56')
S89°28'31"E 330.53'

Lot 2
C.S.M. 3653

recorded as(N0°28'15"E 1318.17')
N0°28'15"E 1316.03'

Tax Parcel
IL 1800026

Lot 2
C.S.M. 1672

Note:
The contours shown on this drawing have been imported from the Walworth County digital mapping and have not been field verified.

recorded as(N0°28'15"E 658.21')
N0°28'15"E 658.08'

Tax Parcel
IL 1800027A

153.20'
(153.20')

Tax Parcel
IL 1800027

153.20'
(153.20')

Southwest Corner of the Northwest 1/4 of the Southwest 1/4 of Section 17-1-17
(N. 190,707.71)
(E. 2,398,529.28)

Tax Parcel
IL 1700014

recorded as(N1°33'20"W 2842.76')State Plane
N0°18'45"E 2842.76'
Straight line from the Northwest corner of Section 17 to the West 1/4 corner of Section 17.

Copyright © 2024 by Olson Land Surveying, LLC.

All rights reserved. No part of this survey plat may be reproduced or transmitted in any form by any means - graphic, electronic, or mechanical, including photocopying, tracing, or information storage and retrieval systems - without permission in writing from Douglas G. Olson, Olson Land Surveying, LLC.

I hereby certify that I have surveyed the above described property in compliance with Chapter A-E 7 of the Wisconsin Administrative Code and that the map hereon is correct to the best of my professional knowledge and belief and shows the size and location of the property, its exterior boundaries, the location and dimensions of all visible structures thereon, boundary fences, apparent easements and roadways and visible encroachments, if any.

This survey is made for the exclusive use of the present owners of the property, and also those who purchase, mortgage or guarantee title thereto, within one year from the date hereof.

Douglas G. Olson
Wisconsin Professional Land Surveyor - 2093

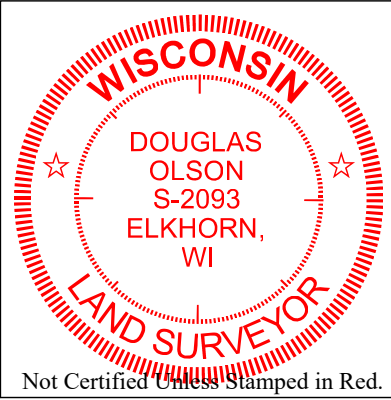

- Notes:**
- 1) This Plat of Survey is not certified unless signed and sealed in red ink.
 - 2) This survey is subject to Wisconsin lien laws. This Plat of Survey is the notice of intent to file lien. Lien waiver required.
 - 3) The Survey Date shown on this Plat of Survey is the completion date of the field work.

Scale in Feet
1" = 40'

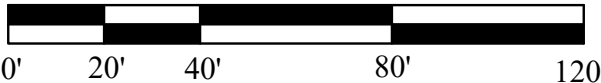

Survey date: February 8, 2024.

Revisions: No. 1 - Walworth County 1' Interval Contours & Waterway East
No. 2 - Misc.

Legend of Symbols & Abbreviations

- Found County Section Corner
- Found Iron Pipe
- Found Iron Rod
- Set Iron Pipe, 1" dia.
- Recorded Information
- Utility Pole
- Concrete Cover
- Septic Vent
- Alphalt Surface
- Concrete Surface
- Gravel Surface
- Brick Pavers

N North
S South
E East
W West
in Bearings
Degrees
Minutes
Seconds
in Distances
Feet
Inches
No. Number
N.W. Northwest
S.E. Southeast
Dia. Diameter



45 South Wisconsin Street | P.O. Box 322
Elkhorn, Wisconsin. 53121
Telephone: (262) 723-3434
Facsimile: (262) 723-8044
Email: doug@olsonsurveying.com
Website: www.olsonsurveying.com