

PLAT OF SURVEY  
LOT 1 OF BLOCK 2 OF LAWRENCE ADDITION TO GENEVISTA, A SUBDIVISION  
LOCATED IN PART OF THE SOUTHWEST 1/4 OF THE SOUTHWEST 1/4 OF SECTION 10, TOWN 1 NORTH, RANGE 17 EAST, WALWORTH COUNTY, WISCONSIN

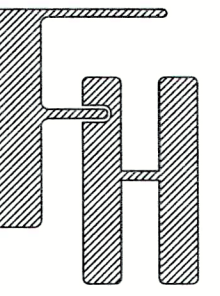

PLAT OF SURVEY  
W3688 GLENMORE AVENUE  
LAKE GENEVA, WISCONSIN

— WORK ORDERED BY —  
WALKER TRUST  
N1742 LINN ROAD  
LAKE GENEVA, WI 53147

FARRIS, HANSEN & ASSOCIATES, INC.  
ENGINEERING — ARCHITECTURE — SURVEYING  
7 RIDGWAY COURT P.O. BOX 437  
ELKHORN, WISCONSIN 53121  
PHONE: (262) 723-2098 e-mail: office@farris-hansen.com

REVISIONS  
08/30/24  
Remove Garden

PROJECT NO.  
11094  
DATE  
08/29/2024  
SHEET NO.  
1 OF 1

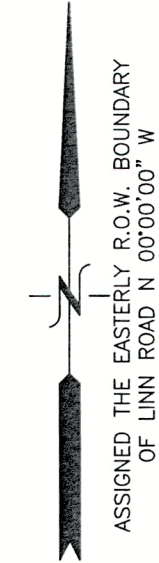

LEGEND  
○ = FOUND IRON PIPE STAKE  
⊕ = UTILITY POLE LOCATED  
— OH — = OVERHEAD WIRES  
{XXX} = RECORDED AS

NOTE: COPIES OF THIS MAP TO WHICH THE FOLLOWING CERTIFICATE WILL APPLY SHOW THE SURVEYOR'S ORIGINAL SEAL AND SIGNATURE IN RED INK. COPIES BY ANY OTHER MEANS MAY HAVE ALTERATIONS WHICH DO NOT REPRESENT THE SURVEYOR'S WORK PRODUCT.

I HEREBY CERTIFY THAT THE ABOVE DESCRIBED PROPERTY HAS BEEN SURVEYED UNDER MY DIRECTION AND THAT THE ABOVE MAP IS A TRUE REPRESENTATION THEREOF AND SHOWS THE SIZE AND LOCATION OF THE PROPERTY AND ITS EXTERIOR BOUNDARIES. THIS SURVEY IS MADE FOR THE USE OF THE PRESENT OWNERS OF THE PROPERTY, AND ALSO THOSE WHO PURCHASE, MORTGAGE, OR GUARANTEE THE TITLE THERETO WITHIN ONE YEAR FROM THE DATE HEREOF. FIELD WORK WAS CONDUCTED 8/5/2024.

DATED: 8/29/2024

CHRISTOPHER A. HODGES  
P.L.S. 2760

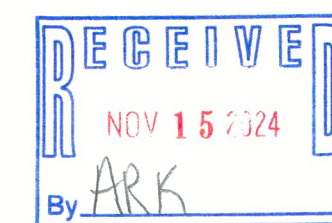
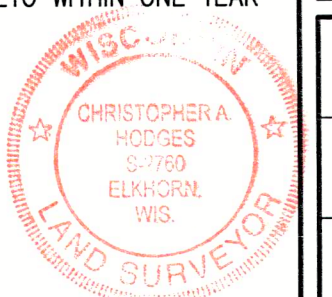

117-4953

JGVL-4

