

# Plat of Survey

of

## Lot 22 of Lake Geneva Highlands,

a subdivision, located in Government Lot 1 in the Southeast 1/4 of Section 8,  
Town 1 North, Range 17 East, Town of Linn, Walworth County, Wisconsin.

Surveyed for: **Thomas O'Connor**  
5760 South Monroe Street  
Hinsdale, Illinois. 60521

Lakeview Road

(50' Wide)

Woodland Road

(50' Wide)

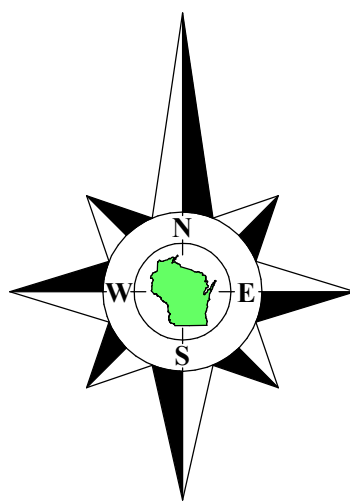

Bearings referenced to the East line of the Northeast 1/4 of Section 17-1-17,  
recorded as N1°39'37"W in the Wisconsin State Plane Coordinate System,  
South Zone, (NAD-27).

Coordinates are referenced to the Wisconsin State  
Plane Coordinate System, South Zone, (NAD-27).

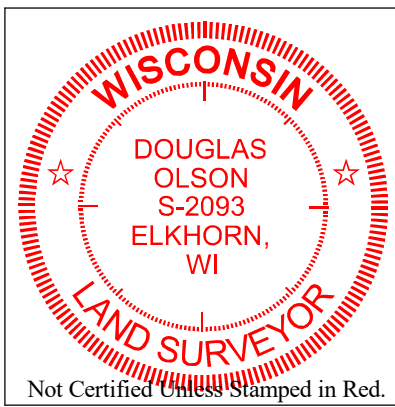

### Notes:

- 1) This Plat of Survey is not certified unless signed and sealed in red ink.
- 2) This survey is subject to Wisconsin lien laws. This Plat of Survey is the notice of intent to file lien. Lien waiver required.
- 3) The Survey Date shown on this Plat of Survey is the completion date of the field work.

Copyright © 2022 by Olson Land Surveying, LLC.

All rights reserved. No part of this survey plat may be reproduced or transmitted in any form by any means - graphic, electronic, or mechanical, including photocopying, tracing, or information storage and retrieval systems - without permission in writing from Douglas G. Olson, Olson Land Surveying, LLC.

I hereby certify that I have surveyed the above described property in compliance with Chapter A-E 7 of the Wisconsin Administrative Code and that the map hereon is correct to the best of my professional knowledge and belief and shows the size and location of the property, its exterior boundaries, the location and dimensions of all visible structures thereon, boundary fences, apparent easements and roadways and visible encroachments, if any.

This survey is made for the exclusive use of the present owners of the property, and also those who purchase, mortgage or guarantee title thereto, within one year from the date hereof.

Douglas G. Olson  
Wisconsin Professional Land Surveyor - 2093

Block Corner  
N 205.115.88  
E 2,403.671.89

Scale in Feet  
1" = 10'



Survey Date: March 21, 2022.

Revisions: No. 1 - Proposed House & Deck  
No. 2 - Impervious Surface Cals.  
No. 3 - Proposed Off Street Parking  
No. 4 - Poured Concrete Foundation

Sheet 1 of 1 Sheets

Drawing Name:

Job Reference Number  
2022.029

### Legend of Symbols & Abbreviations

Found County Section Corner	N North
Found Iron Pipe	S South
Found Iron Rod	E East
Set Iron Pipe, 1" dia.	W West
Recorded Information	In Bearings
Utility Pole	° Degrees
Utility Pedestal	' Minutes
Concrete Cover	" Seconds
Concrete Surface	In Distances
Asphalt Surface	Feet
Stone Pavers	" Inches



45 South Wisconsin Street | P.O. Box 322  
Elkhorn, Wisconsin. 53121  
Telephone: (262) 723-3434  
Facsimile: (262) 723-8044  
Email: doug@olsonsurveying.com  
Website: www.olsonsurveying.com