

PLAT OF SURVEY

LEGAL DESCRIPTION:

A PARCEL OF LAND LOCATED IN THE SOUTHWEST 1/4 OF THE NORTHEAST 1/4 OF SECTION 05 IN TOWNSHIP 01 NORTH, RANGE 17 EAST, IN THE TOWN OF LINN, WALWORTH COUNTY, WISCONSIN.

MORE PARTICULARLY DESCRIBED AS:

LOT 2 OF BLOCK D CISCO BEACH AS RECORDED IN DOCUMENT NO. P259331 PER THE WALWORTH COUNTY REGISTER OF DEEDS.

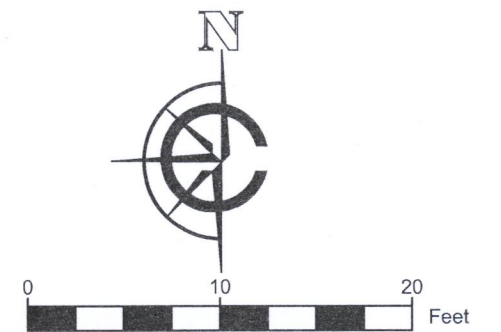

SCALE: 1" = 10'
SHEET SIZE: 11 x 17

LEGEND

	EXISTING BUILDING		FOUND 2" IRON PIPE
	EXISTING ASPHALT		FOUND 1" IRON PIPE
	EXISTING DECK		FOUND IRON ROD
	EXISTING CONCRETE		UTILITY POLE
	PROPOSED ADDITION		FOUND CULVERT / INVERT
	RECORDED AS		
	EXISTING TREE		

BASIS OF BEARING:
THE WISCONSIN STATE PLANE COORDINATE SYSTEM,
NAD-83, SOUTH ZONE

SOUTHERNLY LINE OF LOT 2, BLOCK D CISCO BEACH ASSUMED
TO BE S83°16'41"W.

BUILDING SURVEYED TO:
THE EXTERIOR OF SIDING.

SURVEY ORDERED BY:
BRETT STANCZAK

PROPERTY ADDRESS:
N2334 SHOREVIEW DRIVE
LAKE GENEVA, WI

FIELD WORK COMPLETED ON:
AUGUST 1, 2022

FIELD CREW CHIEF:
MICHAEL MELENZIO

SURVEYOR:
PAUL H. VAN HENKELUM, PLS
CARDINAL ENGINEERING LLC

"I HEREBY CERTIFY THAT I HAVE SURVEYED THE ABOVE DESCRIBED PROPERTY
AND THE MAP IS A TRUE AND CORRECT REPRESENTATION OF ITS EXTERIOR
BOUNDARIES AND SHOWS THE SIZE AND LOCATION OF ALL VISIBLE STRUCTURES,
APPARENT EASEMENTS AND ENCROACHMENTS, IF ANY."

PAUL H. VAN HENKELUM, PLS #1931

DATE

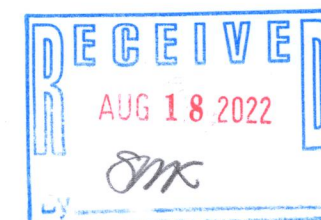
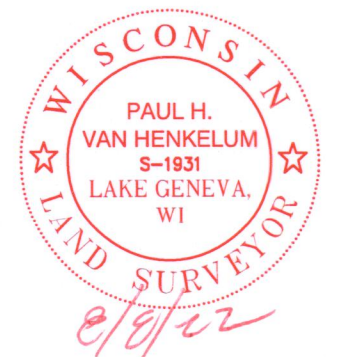



CARDINAL
PLAN | SURVEY | ENGINEER

1200 LA SALLE ST.
LAKE GENEVA, WI 53147
262-757-8776
PLANSURVEYENGINEER.COM

DATE: 08 / 08 / 2022 JOB No. 22383
SHEET 1 OF 1 AJJ

117-4683

PI OTTFD: 8/8/2022 2:08:13 PM