

Wisconsin Professional Land Surveyor S-2582

**N9330 Knuteson Drive
Whitewater, WI 53190
Phone:(262)949-1239
MARKMIRITZ@
LAND-MARKSURVEYING.COM**

GENEVA LAKE
ELEV=864.4' NOV. 5, 2021
100 YEAR FLOOD ELEV=865.0'
FALLS ON RIP RAP

**LOT 10 OF THE BIRCHES SUBDIVISION, LOCATED IN
GOVERNMENT LOT NO. 4 OF SECTION 10, TOWN 1
NORTH, RANGE 17 EAST, TOWN OF LINN, WALWORTH
COUNTY, WISCONSIN.**

OWNER:

LINDA D. JOHNSTIN TRUST
W3628 MAPLE LANE
LAKE GENEVA, WI 53147

LOT 9

LOT 10
66,930 SQ. FT.
1.537 ACRES
ZONED R-1

LOT 11

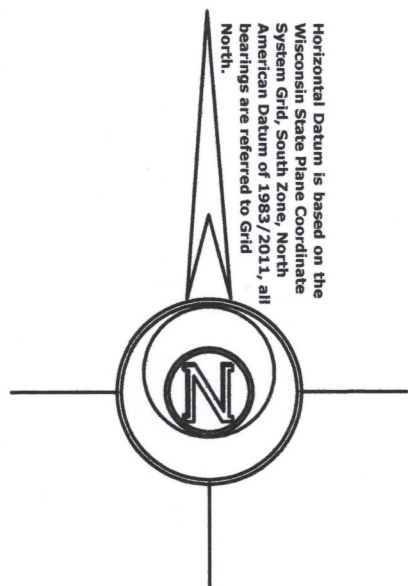

Horizontal Datum is based on the Wisconsin State Plane Coordinate System Grid, South Zone, North American Datum of 1983/2011, and bearings are referred to Grid North.

RES

RES

S 01°57'00" E 743.54

TIMBER RETAINING WALL 0.5' EAST

(559.5')
559.54'
228.40'

TIMBER RETAINING WALL 0.8' EAST

SURVEYOR'S NOTE:

**THIS SURVEY RETRACES A SURVEY BY
GEORGE T. DUNHAM JUNE 18, 1958**

LEGEND

☒ FOUND IRON PIPE

FOUND IRON ROD

 ——— **UTILITY POLE W/ OVERHEAD LINES**

(X X) **RECORDED AS DIMENSION**

~~—Y—X—~~ EXISTING FENCE

SCALE: 1 INCH = 50 FEET

"I hereby certify that the above described property has been surveyed by me or under my direction and that the above map is a true representation thereof and shows the size and location of the property, its exterior boundaries, the location of all visible structures and dimensions of all principal buildings thereon, boundary fences, apparent easements, roadways and visible encroachments, if any."

"This survey is made for the use of the present owners of the property, and also those who purchase, mortgage, or guarantee the title thereto within one year from date hereof."

"This survey is made for the use of the present owners of the property, and also those who purchase, mortgage, or guarantee the title thereto within one year from date hereof."

MARK L. MIRITZ
WISCONSIN PROFESSIONAL
LAND SURVEYOR S-2582

DATE: NOV. 14, 2021 **JOB NO.** 21.1103



FENCE 1.0' W

FENCE 0.70' W

FENCE 0.32' W

60

FENCE 0.24' W

S 64°25'19" W 99.48'
(S 64°30'00" E 99.00')
MAPLE LANE
(50' WIDE)

(S 69°00'00" W 93.00')
S 66°39'05" W 92.53'

IBA-10

117-41020