

NORTH 1/16 CORNER OF
THE SOUTHEAST 1/4 OF
SECTION 18-1-17

NOTE: REFER TO A CURRENT TITLE REPORT FOR
EASEMENTS, RESTRICTIONS OR COVENANTS WHICH
MAY AFFECT THIS PROPERTY.

LEGEND

- FOUND BRASS CAPPED
COUNTY MONUMENT
- FOUND BRASS CAPPED
"ACADEMY ESTATES"
SUBDIVISION MONUMENT
- FOUND IRON PIPE (OUTSIDE
DIAMETER AS NOTED)
- SET 1-5/16" O.D. IRON PIPE
- () RECORDED AS PER C.S.M. #659
- { } RECORDED AS PER DEED
- UTILITY BOX

ACADEMY
LANE

60' WIDE PRIVATE ROAD PLATTED AS OUTLOT 3 ON "ACADEMY ESTATES" SUBDIVISION PLAT

LOT 13 OF "ACADEMY ESTATES"

There is an additional
pipe 2.44" S83°44'E
of actual corner.

PARCEL #1A 65900001
LOT 1 OF C.S.M. NO. 659
1.07 acres including road right-of-way
0.97 acres excluding road right-of-way

PLAT OF SURVEY
-OF-

PARCEL #1A 65900001

LOT 1 OF CERTIFIED SURVEY MAP NO. 659, AS RECORDED IN THE OFFICE OF THE REGISTER OF DEEDS
FOR WALWORTH COUNTY, WISCONSIN ON APRIL 25, 1977 IN VOLUME 3 OF CERTIFIED SURVEY MAPS ON
PAGE 144 AS DOCUMENT NO. 15793 AND BEING PART OF THE NORTHEAST 1/4 OF THE SOUTHEAST 1/4
OF SECTION 18, TOWNSHIP 1 NORTH, RANGE 17 EAST OF THE FOURTH PRINCIPAL MERIDIAN, IN THE TOWN
OF LINN, COUNTY OF WALWORTH AND STATE OF WISCONSIN.

PARCEL #1L 1800025B

ALL THAT PART OF THE SOUTHEAST 1/4 OF SECTION 18, TOWNSHIP 1 NORTH, RANGE 17 EAST, IN THE
TOWN OF LINN, WALWORTH COUNTY, WISCONSIN, BOUNDED AND DESCRIBED AS FOLLOWS, TO-WIT:
COMMENCING AT A POINT 130 FEET SOUTH OF THE NORTHWEST CORNER OF THE SOUTH 1/2 OF THE
NORTH 1/2 OF THE NORTHEAST 1/4 OF THE SOUTHEAST 1/4 OF SECTION 18, T1N, R17E; RUN THENCE
SOUTH PARALLEL WITH THE NORTH AND SOUTH 1/4 SECTION LINE IN SAID SECTION 18, 80 FEET; THENCE
EAST PARALLEL WITH THE EAST AND WEST 1/4 SECTION LINE OF SAID SECTION 18, 260 FEET; THENCE
NORTH PARALLEL WITH THE NORTH AND SOUTH 1/4 SECTION LINE AFORESAID 80 FEET; THENCE WEST
PARALLEL WITH SAID EAST AND WEST 1/4 SECTION LINE 260 FEET TO THE POINT OF BEGINNING.

SURVEY FOR: TRICIA FORBECK OF KEEFE REAL ESTATE
SURVEY ADDRESS: N1462 ACADEMY ROAD, LAKE GENEVA, WI 53147

BEARINGS HEREON RELATE TO THE
WEST LINE OF LOTS 1 AND 2 OF
C.S.M. NO. 659, ASSUMED BEARING OF
SOUTH 00°04'00" WEST AS PLATTED.

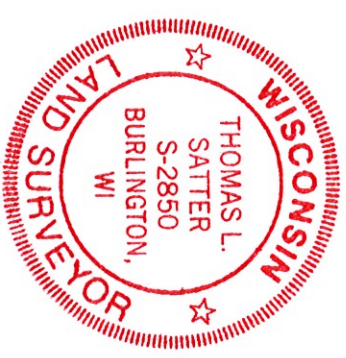

THIS IS NOT AN ORIGINAL PRINT
UNLESS THIS SEAL IS RED.

Thomas L. Satter

THOMAS L. SATTER S-2850

SATTER SURVEYING, LLC
LAND SURVEYS, MAPPING AND PLANNING
272 ORIGEN STREET
BURLINGTON, WI 53105
262-661-4239

0 20' 40' 80'
SCALE: 1" = 40'

APRIL 12, 2021 032112
DATE JOB NUMBER