

LEGEND

- |        |                     |   |                        |
|--------|---------------------|---|------------------------|
| ●      | FOUND 1" IRON PIPE  |   | EXISTING ASPHALT DRIVE |
| •      | FOUND .5" IRON PIPE |   | EXISTING BUILDING      |
| ○      | SET 1" IRON PIPE    |   | EXISTING DECK          |
| ▲      | FOUND MAG NAIL      | ⊙ | SEPTIC LID             |
|        | POWER POLE          | Ⓜ | WELL                   |
| ( XX ) | RECORDED AS         |   |                        |

# PLAT OF SURVEY

A PARCEL OF LAND LOCATED IN THE SOUTHEAST 1/4 OF THE NORTHEAST 1/4 OF SECTION 9 IN TOWNSHIP 1 NORTH, RANGE 17 EAST, IN THE TOWN OF LINN, WALWORTH COUNTY, WISCONSIN.

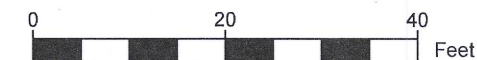

SCALE: 1"=20'

- NOTE:
1. BASIS OF BEARING: THE WISCONSIN STATE PLANE COORDINATE SYSTEM, NAD-83, SOUTH ZONE.
  2. FIELD WORK COMPLETED MAY 26, 2020
  3. BUILDING SURVEYED TO THE EXTERIOR OF SIDING.
- FIELD CREW CHIEF: LOGAN RANDLE

LOT 19  
BIRCHES SUBDIVISION

LEGAL DESCRIPTION:

A PARCEL OF LAND LOCATED IN THE SOUTHEAST 1/4 OF THE NORTHEAST 1/4 OF SECTION 9 IN TOWNSHIP 1 NORTH, RANGE 17 EAST, IN THE TOWN OF LINN, WALWORTH COUNTY, WISCONSIN, MORE PARTICULARLY DESCRIBED AS:

LOT 18 OF THE BIRCHES SUBDIVISION ADD. #1 AS RECORDED IN DOCUMENT P257380 IN THE WALWORTH COUNTY REGISTER OF DEEDS.



SURVEY ORDERED BY:

RJ AMANN BUILDERS

PROPERTY ADDRESS:

1938 SOLAR LA  
LAKE GENEVA, WI 53147

SURVEYOR:

PAUL H. VAN HENKELUM, PLS  
CARDINAL ENGINEERING LLC

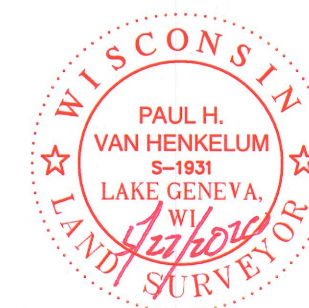

"I HEREBY CERTIFY THAT I HAVE SURVEYED THE ABOVE DESCRIBED PROPERTY AND THE MAP IS A TRUE AND CORRECT REPRESENTATION OF ITS EXTERIOR BOUNDARIES AND SHOWS THE SIZE AND LOCATION OF ALL VISIBLE STRUCTURES, APPARENT EASEMENTS AND ENCROACHMENTS, IF ANY."

*Paul H. Van Henkelum*  
PAUL H. VAN HENKELUM, PLS #1931

*S. J. Kowalski*  
DATE



CARDINAL ENGINEERING LLC  
DESIGNING IN TRUE DIRECTIONS

PO BOX 281 - 1200 LASALLE ST.  
LAKE GENEVA, WI 53147  
262-757-8776  
CARDINALENGINEERINGWI.COM

DATE: 05-27-2020 JOB No. 20358  
SHEET 1 OF 1

1BA1-11A

117-4384