

-OF-



NO.							
-----	--	--	--	--	--	--	--

# PLAT OF SURVEY

TOWN OF LINN, WALWORTH COUNTY, WISCONSIN

---

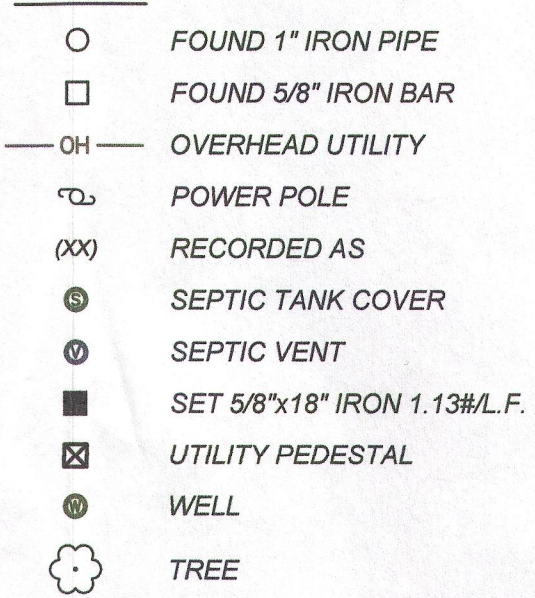

*This survey is made for the exclusive use of the present owners of the property, and also those who purchase, mortgage, or insure the title thereto within one (1) year from date hereof; and as to them I warrant the accuracy of said survey map.*

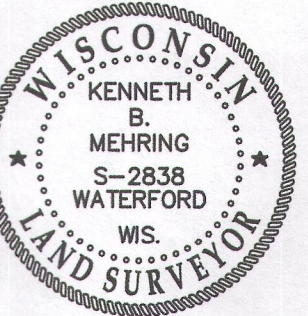

KENNETH B. MEHRING S-2838  
WISCONSIN REGISTERED  
LAND SURVEYOR  
(original if signed in red)