

Plat of Survey

of

Lots 14, 16 and 18 of Shore Haven,

a subdivision located in the Northeast 1/4 of Section 18, Town 1 North, Range 17 East, Town of Linn, Walworth County, Wisconsin.

Surveyed for: **Michael Busch**
235 Sheridan Point Lane NE
Atlanta, Georgia. 30342

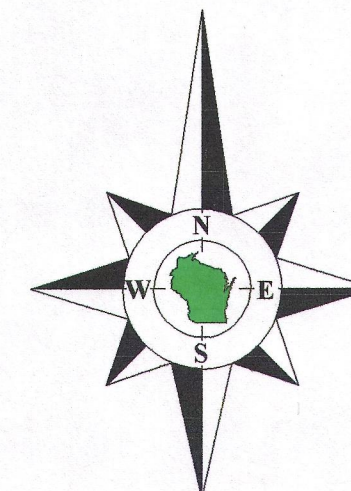

Bearings reference to the East line of Shore Haven Drive, assumed as North.

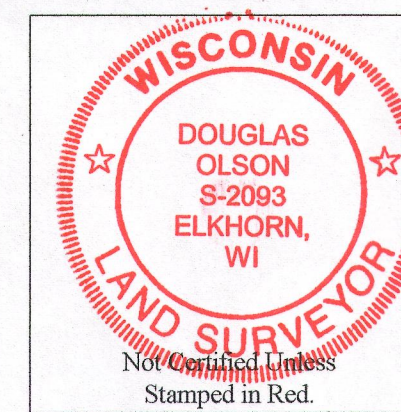

Notes:

- 1) This survey plat is not certified unless signed and sealed in red ink.
- 2) This survey is subject to Wisconsin lien laws. This Plat of Survey is the notice of intent to file lien. Lien waiver required.

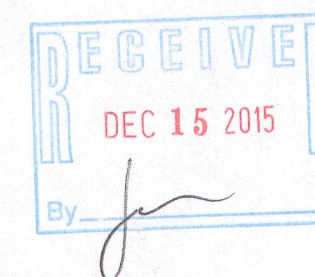

Copyright 2015 by Olson Land Surveying, LLC.

All rights reserved. No part of this survey plat may be reproduced or transmitted in any form by any means - graphic, electronic, or mechanical, including photocopying, tracing, or information storage and retrieval systems - without permission in writing from Douglas G. Olson, Olson Land Surveying, LLC.

I, Douglas G. Olson, Wisconsin Professional Land Surveyor, do hereby certify that this survey was performed by me, or under my direction in full compliance with the owner's/agent's instructions and Chapter A-E 7 of the Wisconsin Administrative Code "Minimum Standards for Property Surveys", and that this map is an accurate representation thereof to the best of my knowledge and belief.

Douglas G. Olson
Wisconsin Professional Land Surveyor - 2093

Survey Date: October 29, 2015.
Revisions: No. 1 - Proposed Lot Line Adjustment

Scale in Feet
1" = 20'

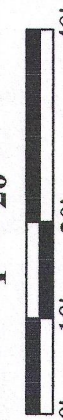

Olson Land Surveying, LLC



45 South Wisconsin Street * P.O. Box 322 * Elkhorn, Wisconsin. 53121
Telephone: (262) 723-3434 * Facsimile: (262) 723-8044
Email: doug@olsonsurveying.com

Legend

- Found Iron Pipe
- Found Iron Rod
- Set Iron Pipe, 1" dia.
- Set Iron Rod, 1" dia.
- Reinforced Concrete
- Utility Pole or Pedestal
- Utility Box or Pedestal
- Asphalt Surface
- Concrete
- Stone or Brick Pavers
- Lamp

Sheet 1 of 1 Sheets

Drawing Name:

Job Reference Number

2015.080

2015.080

18A-13
18A-17 117-3858