

Plat of Survey

of

Lot 1 thru 6 and 44 thru 46 in Block 5 of Maple Hills Subdivision A,

located in the Southeast 1/4 and the Southwest 1/4 of Section 18, Town 1 North, Range 17 East, Town of Linn, Walworth County, Wisconsin.

Surveyed for: **Keefe Real Estate, Inc.**

P.O. Box 460
Lake Geneva, Wisconsin. 53147

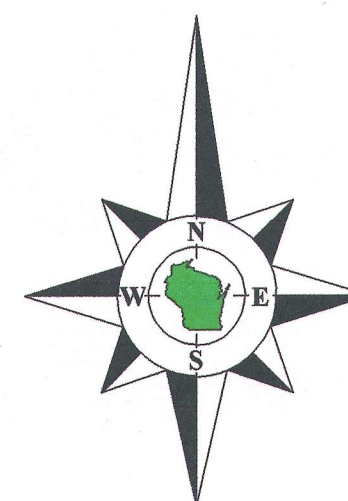

Bearings reference to the
plat of Maple Hills.

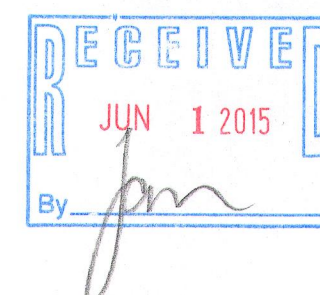
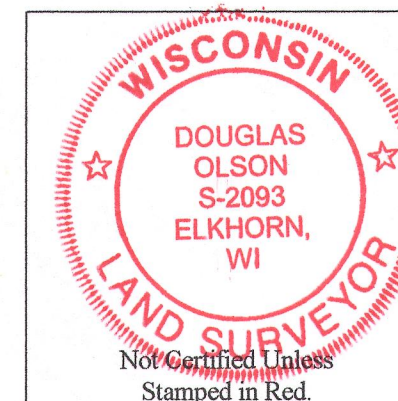

Notes:

- 1) This survey plat is not certified unless signed and sealed in red ink.
- 2) This survey is subject to Wisconsin lien laws. This Plat of Survey is the notice of intent to file lien. Lien waiver required.

Copyright 2014 by Jensen & Olson Land Surveying, LLC.

All rights reserved. No part of this survey plat may be reproduced or transmitted in any form by any means - graphic, electronic, or mechanical, including photocopying, tracing, or information storage and retrieval systems - without permission in writing from Douglas G. Olson, Jensen & Olson Land Surveying, LLC.

I hereby certify that I have surveyed the above described property and the map hereon is correct to the best of my professional knowledge and belief and shows the size and location of the property, its exterior boundaries, the location and dimensions of all visible structures thereon, boundary fences, apparent easements and roadways and visible encroachments, if any.

This survey is made for the exclusive use of the present owners of the property, and also those who purchase, mortgage or guarantee title thereto, within one year from the date hereof.

Douglas G. Olson
Wisconsin Registered Land Surveyor - 2093

Survey Date: May 28, 2014.
Revisions:

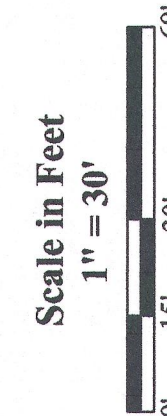

Jensen & Olson Land Surveying, LLC

45 South Wisconsin Street * P.O. Box 322 * Elkhorn, Wisconsin. 53121
Telephone: (262) 723-3434 * Facsimile: (262) 723-8044
Email: jensen.olson@elknet.net

Legend
Found Iron Pipe
Found Iron Rod, Square
Set Iron Pipe, 1" dia.
Recorded Information
Utility Pole
Septic Vent
Asphalt Surface
Gravel Surface

Sheet 1 of 1 Sheets
Drawing Name: t1m17c2014039-2014039Plat.sjg
Job Reference Number
2014.039

2014.039

IMH - 99
IMH - 132
117-3782