

# Plat of Survey

of

## Lot 14 of Camp Sybil,

a subdivision located in the Northeast 1/4 of Section 18, Town 1 North,  
Range 17 East, Town of Linn, Walworth County, Wisconsin.

Surveyed for:

**Peter Bazos**

1112 Crane Drive  
Sleepy Hollow, Illinois. 60118

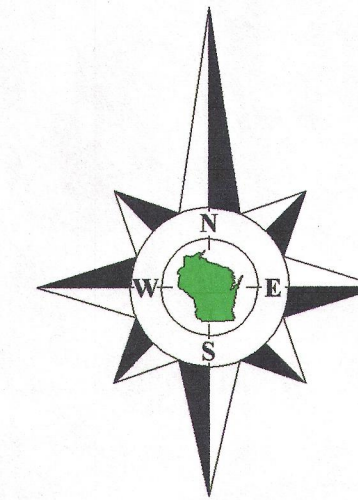

Bearings reference to the Wisconsin State  
Plane Coordinate System, South Zone.

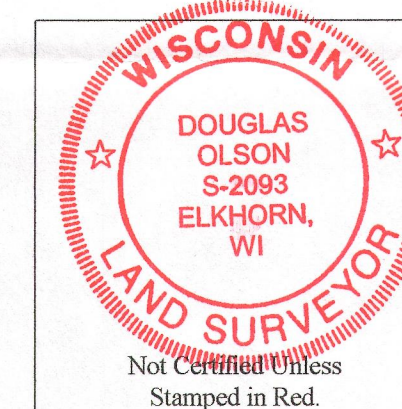

### Notes:

- 1) This survey plat is not certified unless signed and sealed in red ink.
- 2) This survey is subject to Wisconsin lien laws. This Plat of Survey is the notice of intent to file lien. Lien waiver required.

Copyright 2012 by Jensen & Olson Land Surveying, LLC.

All rights reserved. No part of this survey plat may be reproduced or transmitted in any form by any means - graphic, electronic, or mechanical, including photocopying, tracing, or information storage and retrieval systems - without permission in writing from Douglas G. Olson, Jensen & Olson Land Surveying, LLC.

I, Douglas G. Olson, Wisconsin Registered Land Surveyor, do hereby certify that this survey was performed by me, or under my direction in full compliance with the owner's/agent's instructions and Chapter A-E 7 of the Wisconsin Administrative Code "Minimum Standards for Property Surveys"; and that this map is an accurate representation thereof to the best of my knowledge and belief.

Douglas G. Olson  
Wisconsin Registered Land Surveyor - 2093

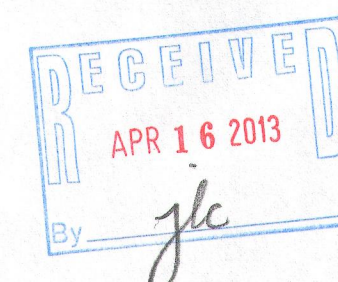

South 1/8 Corner of  
the Northeast 1/4 of  
Section 18-1-17.

East 1/4 Corner  
Section 18-1-17.  
N. 202,349.48  
E. 2,398,457.54

N89°30'42"E 2636.77'  
(N89°30'42"E 2636.77') State Plane

Center 1/4 Corner  
Section 18-1-17.  
N. 202,327.01  
E. 2,395,820.88

Survey Date: Sept. 14, 2012.  
Revisions:

Scale in Feet  
1" = 10'  
0' 5' 10' 20'

**Jensen & Olson Land Surveying, LLC**

45 South Wisconsin Street \* P.O. Box 322 \* Elkhorn, Wisconsin. 53121  
Telephone: (262) 723-3434 \* Facsimile: (262) 723-8044  
Email: jensen.olson@elknet.net

**Legend**  
■ Found County Section Corner  
● Found Iron Pipe  
● Found Iron Rod  
X Set Chiseled Cross  
( ) Recorded Information  
x Utility Pole  
x Utility Pedestal unless noted  
x Asphalt Surface  
x Concrete

Sheet 1 of 1 Sheets  
Job Reference Number  
2012.077

2012.077