

# Plat of Survey

of

## Lot 1 of Certified Survey Map No. 4254,

recorded in Vol. 27 of Certified Survey Maps of Walworth County on Page 139 and located in Government Lot 2 in the Northeast 1/4 of Section 5, Town 1 North, Range 17 East, Town of Linn, Walworth County, Wisconsin.

Surveyed for: **Ian & Julia Stevenson**  
2201 Scoil Court  
Waunakee, Wisconsin. 53597

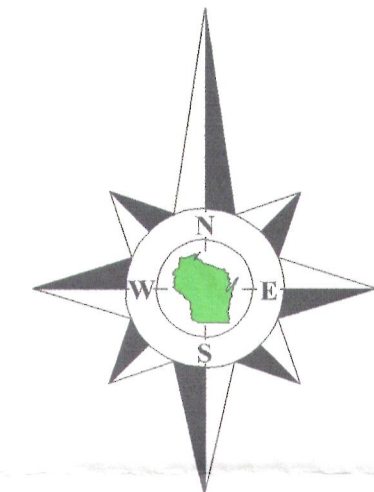

Bearings reference to the Wisconsin State Plane Coordinate System, South Zone.

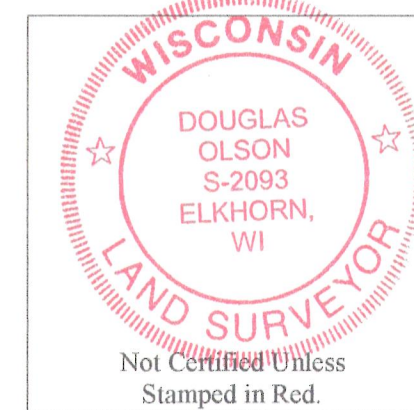

### Notes:

- 1) This survey plat is not certified unless signed and sealed in red ink.
- 2) This survey is subject to Wisconsin lien laws. This Plat of Survey is the notice of intent to file lien. Lien waiver required.

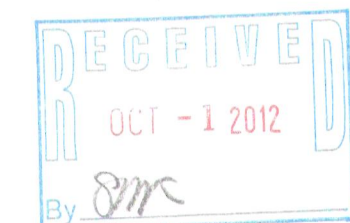

Survey Date: August 7, 2012.  
Revisions:

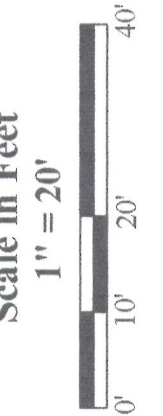

**Jensen & Olson Land Surveying, LLC**  
45 South Wisconsin Street \* P.O. Box 322 \* Elkhorn, Wisconsin. 53121  
Telephone: (262) 723-3434 \* Facsimile: (262) 723-8044  
Email: jensen.olson@elknet.net

**Legend**  
Stone Retaining Wall  
Found Iron Pipe  
Found Iron Rod  
Found Chiseled Cross  
Set Spindle  
Recorded Information  
Concrete Cover  
Utility Pole  
Asphalt Surface  
Concrete

Sheet 1 of 1 Sheets  
Drawing Name: 117-345-2012087 (Plat)  
Job Reference Number  
**2012.087**

**2012.087**

**Knollwood Road**  
(50' Wide)

**Spring Road**  
(66' Wide)

**Shore View Drive**  
(35' Wide)

Lot 8

Lot 51

Lot 52

Lot 7

Lot 6

Lot 55

**Block C**

**Lot 1  
Tax Parcel  
IA425400001**  
0.256 Acre  
11,132 Sq.Ft.

**Garage**

**House  
N2353**

**Wood  
Deck**

**House**

Copyright 2012 by Jensen & Olson Land Surveying, LLC.

All rights reserved. No part of this survey plat may be reproduced or transmitted in any form by any means - graphic, electronic, or mechanical, including photocopying, tracing, or information storage and retrieval systems - without permission in writing from Douglas G. Olson, Jensen & Olson Land Surveying, LLC.

I hereby certify that I have surveyed the above described property and the map hereon is correct to the best of my professional knowledge and belief and shows the size and location of the property, its exterior boundaries, the location and dimensions of all visible structures thereon, boundary fences, apparent easements and roadways and visible encroachments, if any.

This survey is made for the exclusive use of the present owners of the property, and also those who purchase, mortgage or guarantee title thereto, within one year from the date hereof.

Douglas G. Olson  
Wisconsin Registered Land Surveyor - 2093

IA4254-1

117-345