

of  
**Lots 18 and 19 of Lake Geneva Highlands,**  
a subdivision located in Government Lot 1 in the Southeast 1/4 of Section 8,  
Town 1 North, Range 17 East, Town of Linn, Walworth County, Wisconsin.

Surveyed for: **Michael Brenner**  
696 Sumac Road  
Highland Park, Illinois. 60035

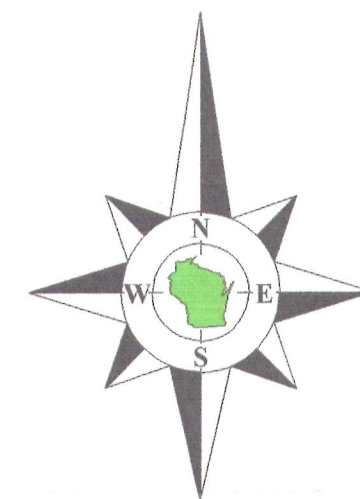

Bearings referenced to previous surveys of record.

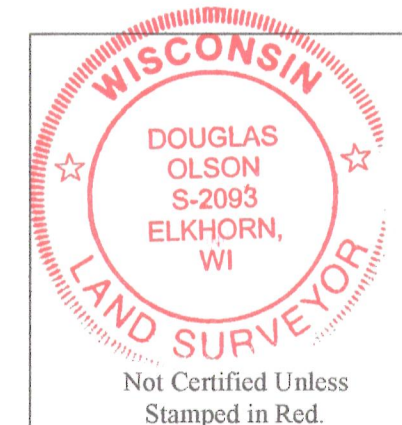

**Note:**

This survey plat is a retracement of prior surveys of Lots 18, 19 and 111 prepared by David F. Abell and Robert M. Barenwald.

**Notes:**

- 1) This survey plat is not certified unless signed and sealed in red ink.
- 2) This survey is subject to Wisconsin lien laws. This Plat of Survey is the notice of intent to file lien. Lien waiver required.

Copyright 2012 by Jensen & Olson Land Surveying, LLC.

All rights reserved. No part of this survey plat may be reproduced or transmitted in any form by any means - graphic, electronic, or mechanical, including photocopying, tracing, or information storage and retrieval systems - without permission in writing from Douglas G. Olson, Jensen & Olson Land Surveying, LLC.

I, Douglas G. Olson, Wisconsin Registered Land Surveyor, do hereby certify that this survey was performed by me, or under my direction in full compliance with the owner's/agent's instructions and Chapter A-E 7 of the Wisconsin Administrative Code "Minimum Standards for Property Surveys"; and that this map is an accurate representation thereof to the best of my knowledge and belief.

Douglas G. Olson  
Wisconsin Registered Land Surveyor - 2093

**Survey Date:** March 14, 2012.  
**Revisions:**

**Scale in Feet**  
1" = 20'



**Jensen & Olson Land Surveying, LLC**  
45 South Wisconsin Street \* P.O. Box 322 \* Elkhorn, Wisconsin, 53121  
Telephone: (262) 723-3434 \* Facsimile: (262) 723-8044  
Email: [jensen.olson@elknet.net](mailto:jensen.olson@elknet.net)

### Legend

- Found Iron Pipe
- Found Iron Rod
- Set Iron Pipe, 1" dia.
- Set Mag Nail
- ( ) Recorded Information
- Utility Pole
- ⊗ Gas Meter
- Spigot
- Asphalt Surface
- Concrete Surface
- Retaining Wall
- Concrete Cover
- Septic Vent
- Pipe Outlet
- Brick or Stone
- Gravel

Sheet 1 of 1 Sheets  
 Drawing Name: t1mr17e-2012014-2012014Platasej  
 Job Reference Number  
**2012.014**

Unit 2

Sills Condominium

ILGH-17 ILGH-18

117.3437