

PREPARED FOR  
EDWARD GRAMS  
617 HOYT DR.  
ELBURN IL. 60119

KROTT SURVEYING INC.

N3705 WILLOW BEND LANE  
LAKE GENEVA WI. 53147  
PHONE # (262)248-3697  
FAX # (262)249-0639

LOT 18

S 88°47'22" E

(S 88°40' E 108.0')

108.10'

PLAT OF SURVEY

-OF-

LOTS 12-17 BLOCK 4 MAPLE HILLS "A"  
A SUBDIVISION LOCATED IN T1N, R17E,  
WALWORTH COUNTY, WISCONSIN.

LOT 17

LOT 16

LOT 15

LOT 14

LOT 13

LOT 12

LOT 11

C.L. MAPLE HILLS DRIVE

(50' WIDE)

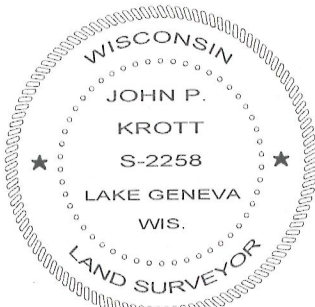
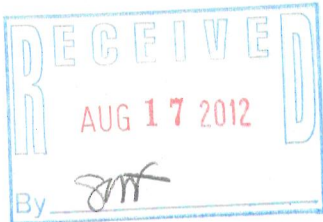

DATE OF LAST REVISION: 8 / 22 / 2012  
DATED THIS 21st DAY OF AUGUST 2012

*John P. Krott*

JOHN KROTT S - 2258  
Wisconsin Registered Land Surveyor  
(original if signed in red)

LEGEND

□ FOUND IRON BAR

○ WELL

⊕ CONCRETE LID

(XX) RECORDED AS

TAX ID # IMH 00072 & 72A

JOB # 03-164UD2012

I have surveyed the above-described property and the above map is a true representation thereof and shows the size and location of the property, its exterior boundaries, the location and dimensions of all structures thereon, fences apparent easements and roadways and visible encroachments, if any.

This survey is made for the exclusive use of the present owners of the property, and also those who purchase, mortgage, or insure the title thereto within one (1) year from date hereof; and as to them I warrant the accuracy of said survey map.

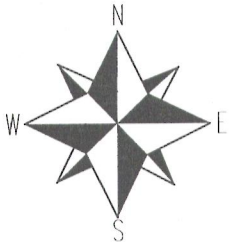

SCALE 1" = 20'



IMH-72 & 72A

117-3435