

PREPARED FOR
BORDER CARPENTRY
N2623 SCHOFIELD RD.
LAKE GENEVA WI. 53147

PLAT OF SURVEY

-OF-

LOTS 20, 21 AND 43 OF THE BIRCHES SECOND ADDITION,
TOWN 1 NORTH, RANGE 17 EAST, WALWORTH COUNTY, WISCONSIN.

KROTT SURVEYING INC.

N3705 WILLOW BEND LANE
LAKE GENEVA WI. 53147
PHONE # (262)248-3697
FAX # (262)249-0639

C.L. MAPLE LANE

R=30.00' L=59.92'
LC=50.44' LCB=N 03°09'46" E

C.L. CENTER STREET

EXISTING HOUSE

LOT 43

FOUND AXLE
N 09°41'04" E 1.04'
FROM CORNER

LOT 42

LOT 41

LOT 21

LOT 22

LOT 20

LEGEND

- FOUND IRON PIPE
- FOUND IRON BAR
- ⊠ FOUND AXLE
- ⊙ WELL
- ⊕ CONCRETE LID
- ⊗ UTILITY POLE
- OVERHEAD WIRES

(XX) RECORDED AS

TAX ID # IBA200007

JOB # 12-060

I have surveyed the above-described property and the above map is a true representation thereof and shows the size and location of the property, its exterior boundaries, the location and dimensions of all structures thereon, fences apparent easements and roadways and visible encroachments, if any.

This survey is made for the exclusive use of the present owners of the property, and also those who purchase, mortgage, or insure the title thereto within one (1) year from date hereof; and as to them I warrant the accuracy of said survey map.

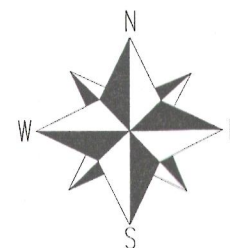

SCALE 1"=30'



FOUND AXLE
N 09°41'04" E 1.04'
FROM CORNER

AREA=156 SQ FT
GAZEBO

FOUND AXLE
N 26°15'55" W 0.15'
FROM CORNER

R=30.00' L=31.97'
LC=30.48' LCB=N 88°56'34" W

SUNNYSIDE AVENUE
(50' WIDE)

DATED THIS 13th DAY OF JUNE, 2012.

John P. Krott
JOHN KROTT S - 2258
Wisconsin Registered Land Surveyor
(original if signed in red)

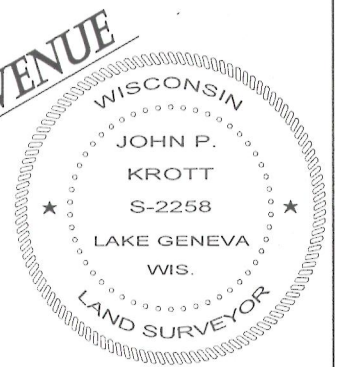

117-3423