

## PLAT OF SURVEY

-OF-

LOT 2 CERTIFIED SURVEY MAP NO. 1547 LOCATED IN THE SOUTHEAST 1/4 OF SECTION 8, T1N, R17E, TOWN OF LINN, WALWORTH COUNTY, WISCONSIN. AND RECORDED IN VOLUME 7 OF CERTIFIED SURVEY MAPS ON PAGE 175

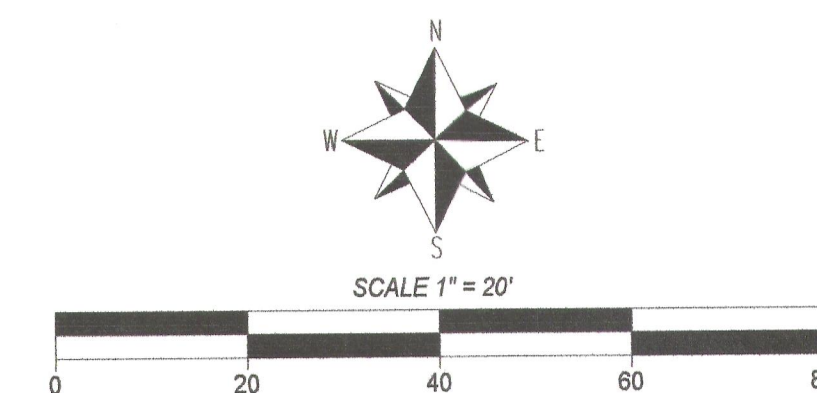

### LEGEND

- FOUND IRON PIPE
- FOUND IRON BAR
- (XX) RECORDED AS  
TAX ID # 1A154700002  
JOB # 99-292

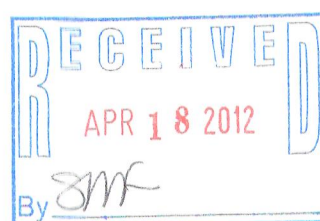

I have surveyed the above-described property and the above map is a true representation thereof and shows the size and location of the property, its exterior boundaries, the location and dimensions of all structures thereon, fences, apparent easements and roadways and visible encroachments, if any.

This survey is made for the exclusive use of the present owners of the property, and also those who purchase, mortgage, or insure the title thereto within one (1) year from date hereof, and as to them I warrant the accuracy of said survey map.

DATED THIS 20th DAY OF MARCH 2012

JOHN KROTT S - 2258  
Wisconsin Registered Land Surveyor  
(original if signed in red)

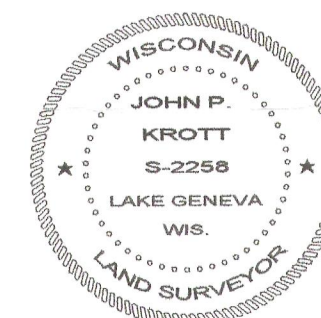

117-3376