

PREPARED FOR
LOIS WHITING
N1932 S. LAKE SHORE DR.
LAKE GENEVA WI 53147

KROTT SURVEYING INC.
N3705 WILLOW BEND LANE
LAKE GENEVA WI. 53147
PHONE # (262)248-3697
FAX # (262)249-0639

PLAT OF

THE WEST LINE OF LOT 4 CERTIFIED SURVEY MAP NO. 1507 AND THE WEST LINE OF LOT 1 CERTIFIED SURVEY MAP NO. 369 ALL LOCATED IN THE NORTHEAST 1/4 AND THE SOUTHEAST 1/4 OF SECTION 11, TOWN 1 NORTH, RANGE 17 EAST, WALWORTH COUNTY, WISCONSIN.

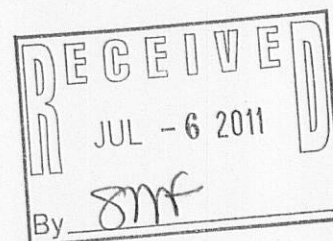

LOT 1
CERTIFIED SURVEY MAP NO. 4139

1.2'

S 0°57'38" E

365.16' +/-

1.8'

LOT 1
CERTIFIED SURVEY MAP NO. 369
(NORTH 240.00')
238.81'

1.6'

ELECTRICAL TRANSFORMER

2.1'

0.8'

1.2'

LEGEND

○ FOUND IRON PIPE

—x— 2 WIRE FENCE

—/— WOOD POST AND WIRE FENCE

(xx) RECORDED AS

TAX ID # (A1507-4 & A369-1)

JOB # 09-056 LOT LINE

GENEVA LAKE

24.72' +/-

PATH

SHORE

0.7'

SHED CORNER
IS 0.5' WEST
OF LOT LINE

EAVE ENCROACHES 0.5'

SHED

EAVE ENCROACHES 0.8'

SHED CORNER
IS 0.4' WEST
OF LOT LINE

(N 0°57'15" W 125.34')
-- 126.35' --
101.63'

FENCE IS ONLINE

MATCH LINE

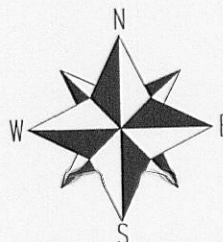

SCALE 1" = 20'

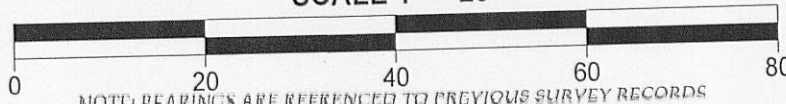

NOTE: BEARINGS ARE REFERENCED TO PREVIOUS SURVEY RECORDS

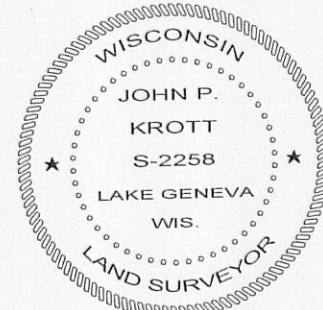

DATED THIS 27th DAY OF MAY 2011.

John P. Krott

JOHN KROTT S - 2258
Wisconsin Registered Land Surveyor
(original if signed in red)

117-3312