

PREPARED FOR:  
LINDA STAREK  
W3751 PARKER DR.  
LAKE GENEVA, WI 53147

PLAT OF SURVEY

-OF-

LOTS 6, 7, 80, 81, 82 AND 83, BLOCK 4, LAKE VIEW PARK  
SUBDIVISION, IN THE NORTHEAST 1/4 OF THE NORTHEAST  
1/4 OF SECTION 16, TOWN 1 NORTH, RANGE 17 EAST, TOWN  
OF LINN, WALWORTH COUNTY, WISCONSIN.

KROTT SURVEYING INC.

N3705 WILLOW BEND LANE  
LAKE GENEVA WI. 53147  
PHONE # (262) 248-3697  
FAX # (262) 249-0639



LEGEND

- ⊙ VENT
- ⊕ CONCRETE ACCESS COVER
- ⦿ WELL
- ⦿ TELEPHONE PEDESTAL
- FOUND IRON PIPE
- FOUND IRON BAR
- SET IRON BAR
- (XX) RECORDED AS

JOB # 11-079 TAX ID # ILVP 00018A & 26J

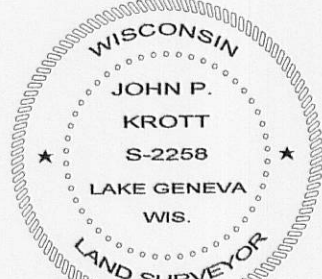
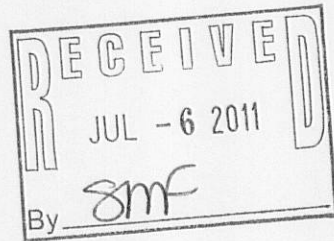
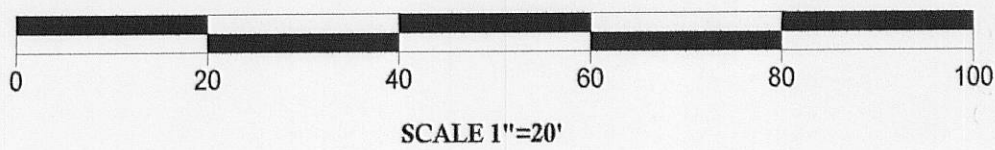
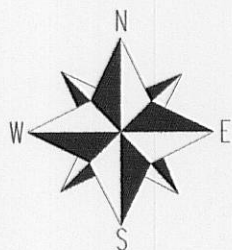

DATED THE 27th, DAY OF MAY, 2011

JOHN KROTT S - 2258  
Wisconsin Registered Land Surveyor  
(original if signed in red)

I have surveyed the above-described property and the above map is a true representation thereof and shows the size and location of the property, its exterior boundaries, the location and dimensions of all structures thereon, fences apparent easements and roadways and visible encroachments, if any.

This survey is made for the exclusive use of the present owners of the property, and also those who purchase, mortgage, or insure the title thereto within one (1) year from date hereof; and as to them I warrant the accuracy of said survey map.

117-3307