

HAROLD H. KOLB

REGISTERED PROFESSIONAL LAND SURVEYOR
LAKE GENEVA, WISCONSIN

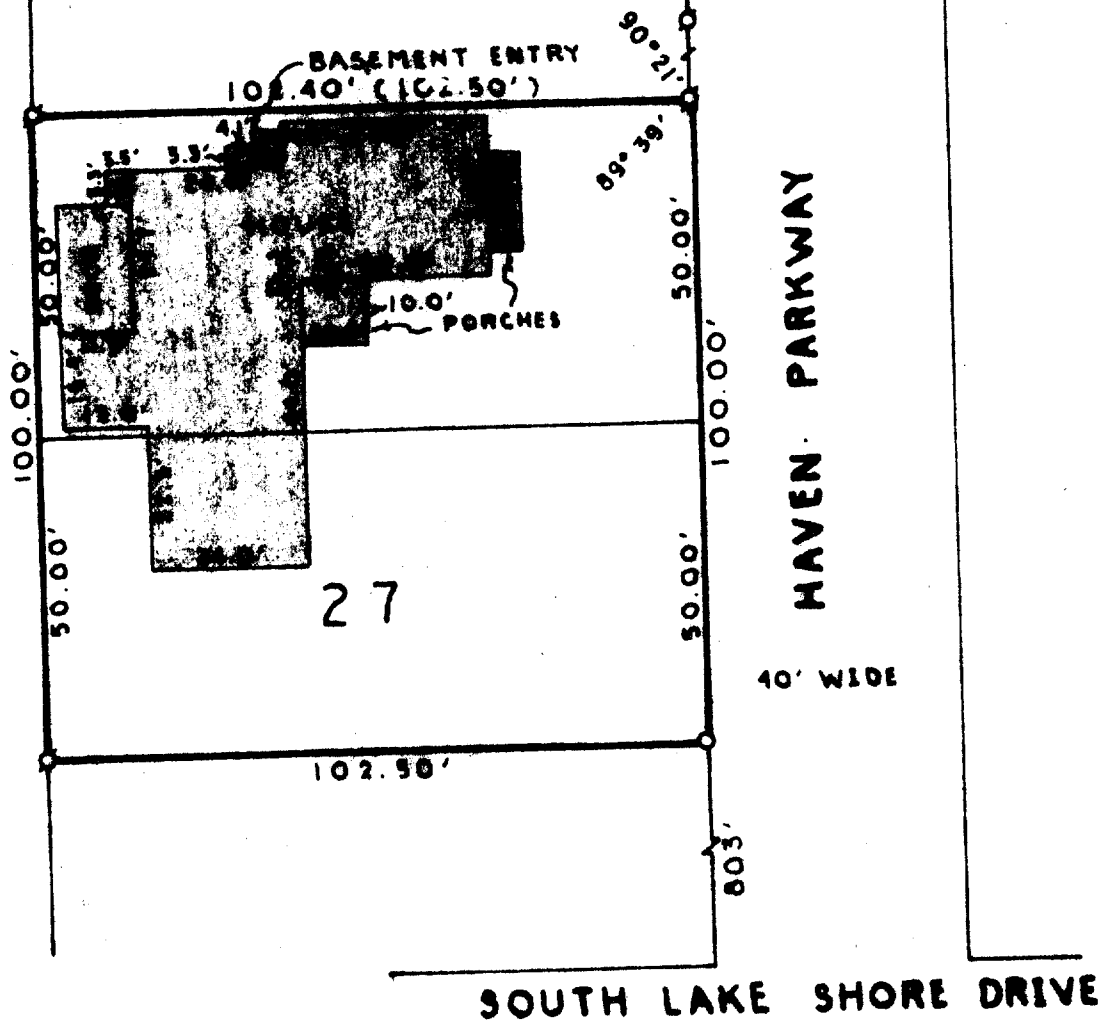

PLAT OF SURVEY OF
SCALE: 1" = 30' Lots 25 and 27, Shore Haven, a subdivision located in T 1 N, R 17 E, Walworth County, Wisconsin.

LEGEND

- φ - IRON PIPE FOUND
- - IRON PIPE PLACED
- - CONCRETE MONUMENT
- x - SPIKE

ISH-24,26



I, HAROLD H. KOLB, DO HEREBY CERTIFY THAT I HAVE SURVEYED THE PROPERTY HEREON DESCRIBED ACCORDING TO THE OFFICIAL RECORDS, AND THAT THE PLAT HEREON IS A CORRECT REPRESENTATION OF THE LOT LINES, and the principle lines of the buildings thereon.

Harold H. Kolb

HAROLD H. KOLB
WISCONSIN REGISTERED LAND SURVEYOR, S-187

DATE July 15, 1971

117-279