

EROSION CONTROL PLAN
PLAT OF SURVEY
LOT 2 OF C.S.M. 3766
REC. IN VOL. 22 ON PG. 300 AS DOC. NO. 630888
PART OF THE NE 1/4 SECTION 15
TOWN 1 NORTH, RANGE 17 EAST
WALWORTH COUNTY, WISCONSIN

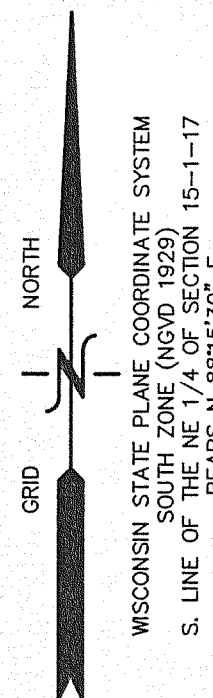

- LEGEND
- = FOUND IRON REBAR STAKE
 - = FOUND IRON PIPE STAKE
 - {XXX} = RECORDED AS
 - ⊕ = SOIL BORING

2006 RESURVEY ORDERED BY:
KEEFE REAL ESTATE
PO BOX 460
LAKE GENEVA, WI. 53147

NOTE: COPIES OF THIS MAP TO WHICH THE FOLLOWING CERTIFICATE WILL APPLY SHOW THE SURVEYOR'S ORIGINAL SEAL AND SIGNATURE IN RED INK. COPIES BY ANY OTHER MEANS MAY HAVE ALTERATIONS WHICH DO NOT REPRESENT THE SURVEYOR'S WORK PRODUCT.

I HEREBY CERTIFY THAT THE ABOVE DESCRIBED PROPERTY HAS BEEN SURVEYED UNDER MY DIRECTION AND THAT THE ABOVE MAP IS A TRUE REPRESENTATION THEREOF AND SHOWS THE SIZE AND LOCATION OF THE PROPERTY AND ITS EXTERIOR BOUNDARIES. THIS SURVEY IS MADE FOR THE USE OF THE PRESENT OWNERS OF THE PROPERTY, AND ALSO THOSE WHO PURCHASE, MORTGAGE, OR GUARANTEE THE TITLE THERETO WITHIN ONE YEAR FROM THE DATE HEREOF.

DATED: DECEMBER 7, 2004

RESURVEYED
11-16-2006

Peter S. Gordon
PETER S. GORDON R.L.S. 2101

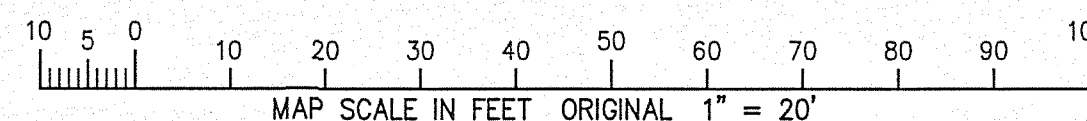
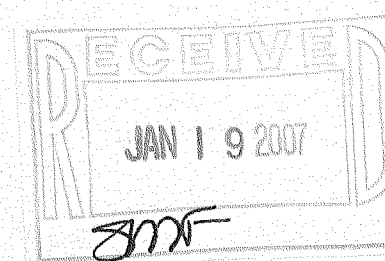

WORK ORDERED BY -
NEIL BIDWELL REV. TRUST
C/O JOE BIDWELL
1022 TARRANT DRIVE
FONTANA, WI

FARRIS, HANSEN & ASSOCIATES, INC.
ENGINEERING - ARCHITECTURE - SURVEYING
7 RIDGWAY COURT P.O. BOX 437
ELKHORN, WISCONSIN 53121
OFFICE: (262) 723-2098 FAX: (262) 723-5886

REVISIONS
05/22/2006
SITE, GRADING,
DRAINAGE, &
EROSION
CONTROL PLAN
08/10/2006
MISC. REVISIONS

PROJECT NO.
6024.02
DATE:
01/09/06
SHEET NO.
1 OF 1

117-2758

11/16/2006 X:\Projects\6024\DCAD\Lot_2

1A3766-2