

PREPARED FOR:
MARIE KEBBEKUS
N1401 BIRD LN.
FONTANA , WI 53125

PLAT OF SURVEY

PATHFINDER SURVEYING INC.
N3705 WILLOWBEND LANE
LAKE GENEVA, WI, 53147
262-248-3697

- OF -
LOTS 3 AND 4 BLOCK 16 , MAPLE HILLS "A" SUBDIVISION,
LOCATED IN T.1.N. , R.17.E. , WALWORTH COUNTY , WISCONSIN.

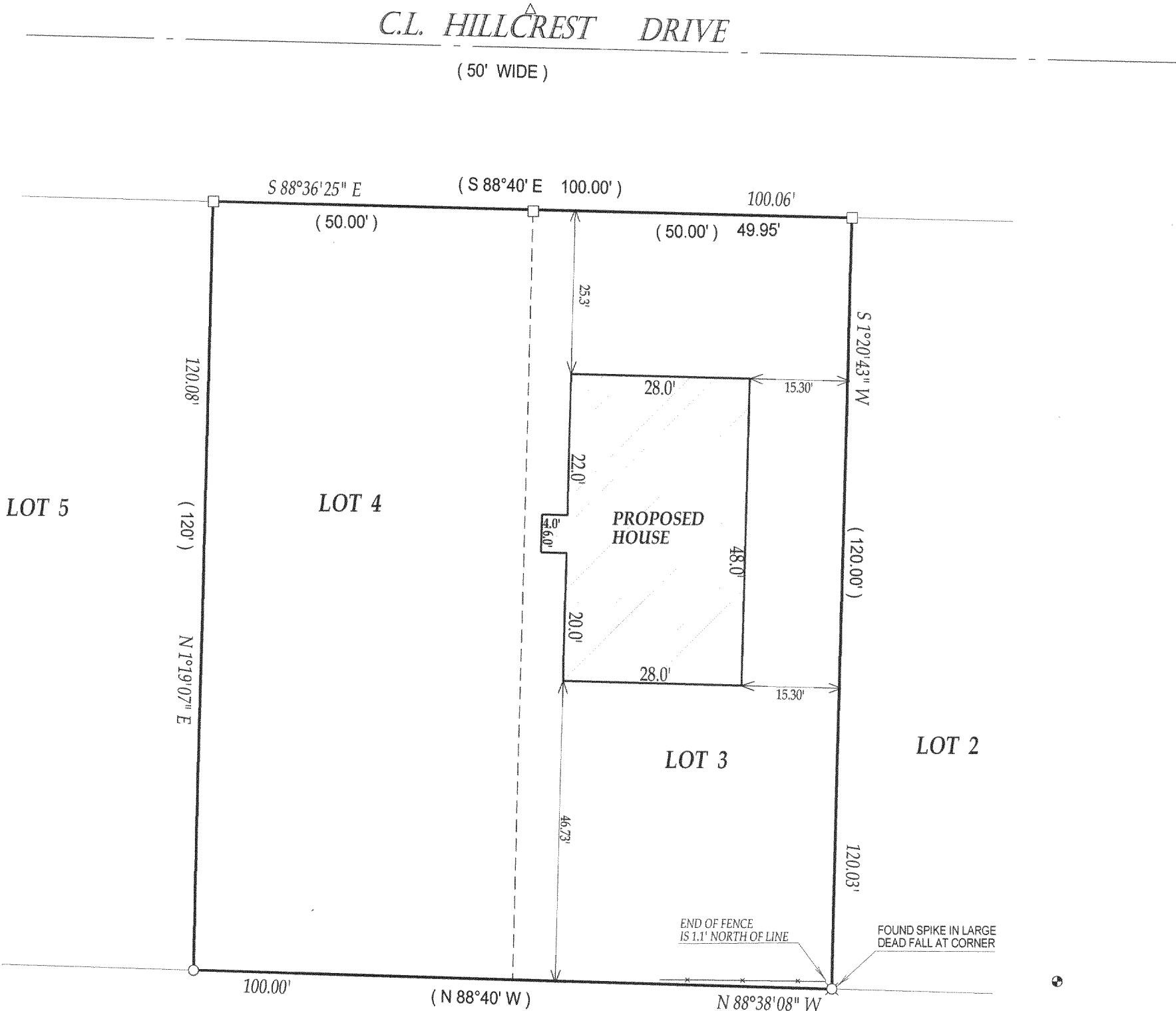

LEGEND

- () = recorded as
- = found iron bar
- = found iron pipe
- = set iron pipe
- = set iron bar

SCALE 1" = 20'

JOB # 05-590

TAX ID # IMH00310

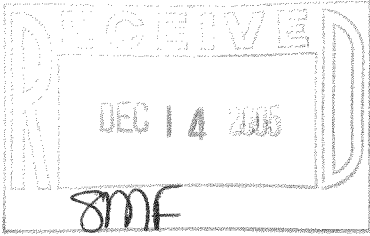
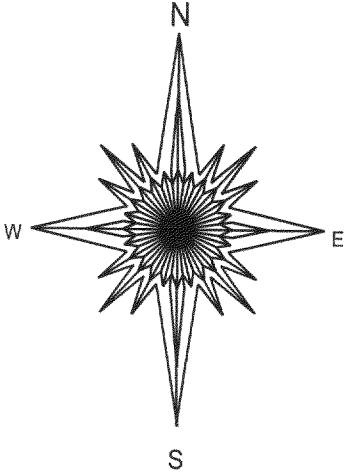

COMPARE LEGAL DESCRIPTION ABOVE AND DRAWING WITH DEED. FOR BUILDING RESTRICTIONS AND EASEMENTS NOT SHOWN, REFER TO DEED, ABSTRACT SOURCES AND LOCAL MUNICIPAL CODES. NOTIFY THE SURVEYOR IMMEDIATELY OF ANY DISCREPANCY.

"I hereby certify that I have surveyed the above described property and that the above map is a true representation thereof and shows the size and location of all visible structures, apparent easements and encroachments if any."
This survey is made for the present owners of the property, and those who purchase, mortgage, or guarantee the title thereto, within one year from the date hereof.

DATED THIS 11th, DAY OF NOVEMBER , 2005



Jeffrey L. Kimps
JEFFREY L. KIMPS S - 2436
Wisconsin Registered Land Surveyor
(original if signed in red)

IMH - 310

117-2634