

GENEVA LAKE

70.2
TOP OF ROCKS

69.6
TOP OF ROCKS

70.4
TOP OF ROCKS

69.3
TOP OF ROCKS

72.8

131.04'

81.0

131.04'

S21°57'00"E

vent

vent

86.0

concrete cover

115.39'

N43°29'57"W

(N41°50'00"W)

94.2

96.4

97.6

94.7

97.6

97.0

98.0

96.3

96.4

97.1

97.1

102.6

101.5

101.2

138.44'

283.6'±

EXISTING DWELLING
(see detail)

PROPOSED COVERED
1st Floor

attached garage

brick deck

97.6

97.0

98.0

96.3

96.4

97.1

97.1

102.6

101.5

101.2

138.44'

283.6'±

CHORD = 587'15" (S62°10')

LEGEND

- FOUND IRON PIPE
- FOUND AXEL ROD
- ⊙ FOUND P.K. NAIL
- 76.9 EXISTING ELEVATION
- b+* BASE OF WALL
- t+* TOP OF WALL

SURVEY FOR: HACKBARTH BUILDERS
SURVEY LOCATION: N1959 SOLAR LANE

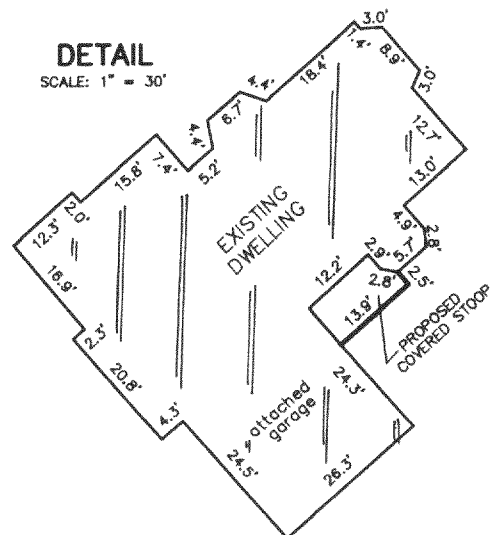

BEARINGS HEREON RELATE TO THE WESTERLY
LINE OF LOT 22 OF THE BORCHES FIRST
ADDITION, ASSUMED BEARING S21°57'00"E.

○	FOUND IRON PIPE
●	FOUND AXEL ROD
∅	FOUND P.K. NAIL
16.9	EXISTING ELEVATION
▽	BASE OF WALL
▽	TOP OF WALL

"I hereby certify that I have surveyed the above described property and that the above map is a correct representation thereof and shows the size and location of the property, its exterior boundaries, the location of all visible structures and dimensions of all principal buildings thereon, boundary fences, apparent easements, roadways and encroachments, if any."

"This survey is made for the use of the present owners of the property, and those who purchase, mortgage, or guarantee the title thereto within one year from date hereof."

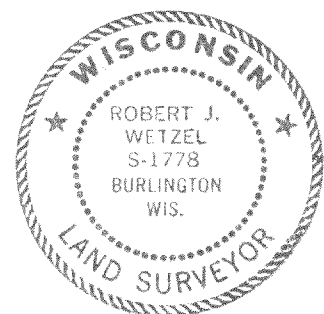
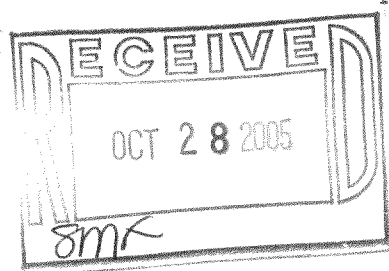

THIS IS NOT AN ORIGINAL PRINT
UNLESS THIS SEAL IS RED.

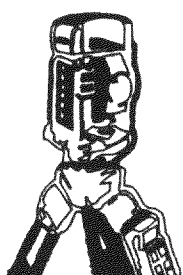

LAND SURVEYS
MAPPING AND PLANNING
412 N. PINE STREET
BURLINGTON, WI 53105
(262)-767-0225

Robert J. Wetzel
ROBERT J. WETZEL S-1778

AUGUST 11, 2005
DATE

6967
JOB NUMBER

IBA1 - 13

117-2610